

THERMOCOUPLES

—SHEATHED THERMOCOUPLES • HEAT PROOF TYPE/COUPLING NIPPLE FOR THERMOCOUPLE—

THERMOCOUPLES

—SCREW TYPE—

☉ Non JIS material definition is listed on P.1351 - 1352

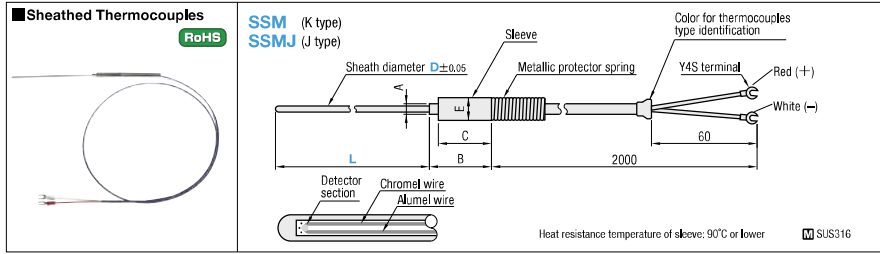

Thermocouples type (Color)	Strand resistance Ω/m	A	B	C	E	Max. usable temperature	Part Number		L	U/Price 1~9					
							Type	D		50mm increments	L50	L100	L150	L200	L250
K type (Blue)	52.0	2.7	35	30	6.0	500°C	SSM	1	50~300						
	20.0					1.6									
	9.8					2.3									
	5.0					3.2									
	2.25					4.8									
J type (Yellow)	33.6	2.7	35	30	6.0	450°C	SSMJ	1	50~150						
	12.8					1.6									
	6.3					2.3									
	3.2					3.2									
	1.4					4.8									

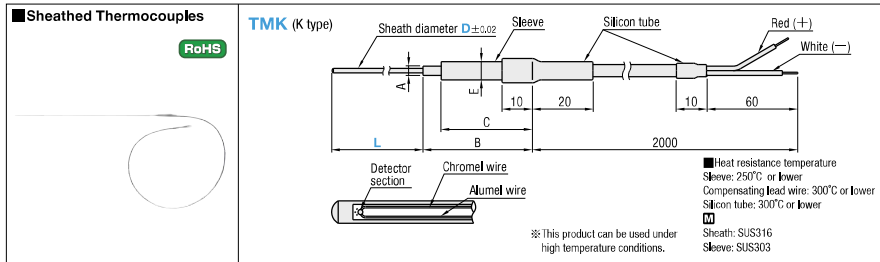

Thermocouples type	Max. usable temperature	A	B	C	E	H	Part Number		L	U/Price 1~9					
							Type	D		50mm increments	L50	L100	L150	L200	L250
K type	650°C	2.8	36	30	5.0	7.0	TMK	1	50~300						
	700°C									1.6					
	750°C									2.3					
	800°C									3.2					

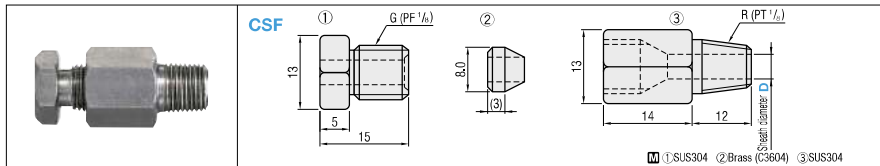

Part Number	U/Price			
		Type	D	1~9
CSF	Quotation	1		
		1.6		
		2.3		
		3.2		

Part Number	L
TMK1.6	100
SSM1	50
CSF 1	

Order Days to Ship Price Quotation

EX Example Tightening the plug (1) causes the component (2) to tighten the thermocouple's sheath and firmly fasten it.

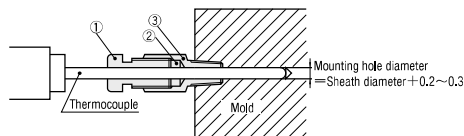

Price Quotation

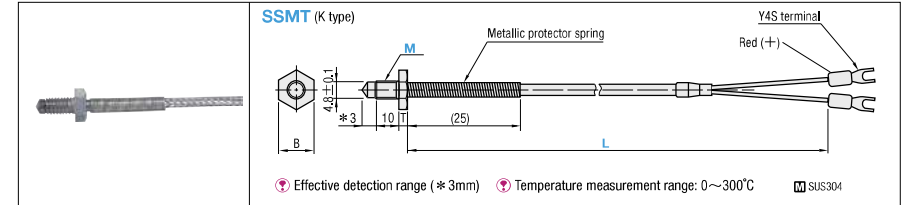

B	T	Part Number		L	U/Price 1~9			Order	Part Number	L	
		Type	M		L1000	L2000	L4000				SSMT6
10	4	SSMT	6	1000			Quotation	Days to Ship	Quotation	Price	Quotation
13	5.3		8	2000	4000						

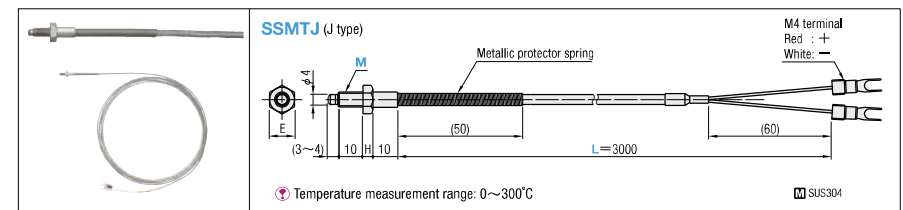

Max. usable temperature (°C)	Tip Point Material	E	H	Part Number			U/Price	
				Type	M	L	1~9	10~19
300	SUS304	10	4	SSMTJ (J type)	6	3000		Quotation

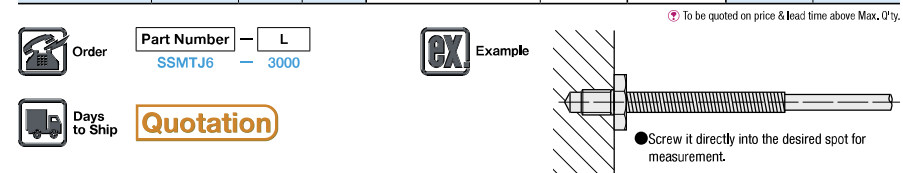

Guide for thermocouples type

Thermocouples type	Color	+ wire	- wire	Usable temperature	Max. usable temperature	Application
K type	Blue	Chromel	Alumel	-200°C ~ 1000°C	1200°C	Most commonly used type for industrial applications. Exhibits a linear Alumel relationship between temperature and thermoelectromotive force.
J type	Yellow	Steel	Constantan	0°C ~ 600°C	750°C	Has high thermoelectromotive characteristics. Used in the medium temperature zone for industrial applications.

* The maximum temperature used differs according to the strand diameter, so use it only as a rough guide.