

BLADES FOR ROUND TYPE / SQUARE TYPE AIR NIPPERS

shows in red

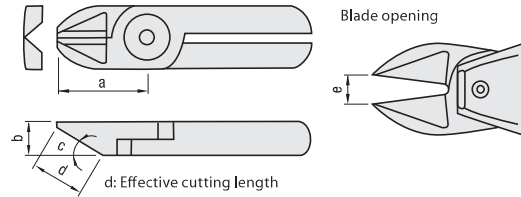

MN □



How to read part number No. MN5 A S

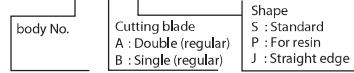

■ Shape

S: Standard

Suitable for cutting steel wires such as copper wire and iron wire

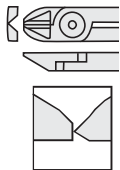

JL, J141, J163: Straight long blades for plastic

Suitable when there is distance between the nippers and the gate cut portion of the workpiece.

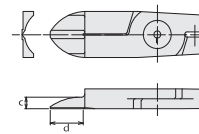

P: For resin

Standard blade used for cutting resin

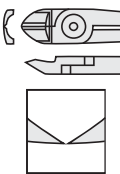

H: Crank blades for plastic

Effective when there are obstructions or the gate is narrow.

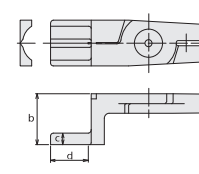

BJ: Straight blades for metals  
This is a set of vertical blades with an unveled cutting edge for metal.

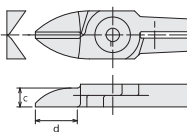

ML □□□□, MR □□□□: Laterally facing blades for plastic  
Useful when it is hard for the nipper to get into, for example, in cramped spaces.

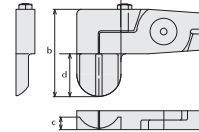

J, JB: Straight blades for plastic  
Vertical blades with an unveled cutting edge for plastic.

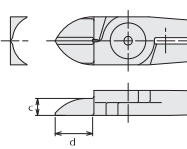

L525: L blades for S  
for direct gate cut.

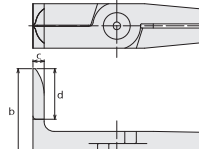

E: Nipping blades for plastic  
Used for plastic gates such as ride gates and discard gates.

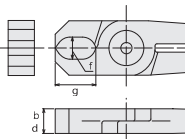

Applicable models	Cutting capacity φ (mm)				a	b	c	d	e	Weight (g)	Part Number			Unit Price
	Soft resin	Hard resin	Copper wire	Iron wire							Body No.	Cutting edge	Shape	
MGT—NS3 MGT—NR3	-	-	1	0.5	24	7	25	12	4	35	MN3	A	S	
	2	-	-	-	24	7	15	11.5	4	35		A	P	
	2	-	-	-	20	7	f6 g 11	7	3.5	35		A	E	
MGT—NS5 MGT—NR5	-	-	1	0.5	24	7	25	12	4	40	MN5	A	S	
	2	-	-	-	24	7	15	11.5	4	40		A	P	
	2	-	-	-	20	7	f6 g 6.6	7	3.5	40		A	E	
MGT—NS7 MGT—NR7	3	2	-	-	27	9	30	11.5	4	80	MN7	A	P	
	3	2	-	-	26	9	f8 g 14.8	9	4	85		A	E	
MGT—NS10L MGT—NR10L	-	-	1.8	1.2	35	12	30	20	5	120	MN10L	A	S	
	4	2.6	-	-	35	12	15	16	5	120		A	P	
	3.5	2	-	-	61	12	7	34	10	165		A	J141	
MGT—N20 MGT—NS20 MGT—NR20 MGT—NB20	-	-	2.6	2	35	12	30	20	9	140	MN20	A	S	
	7	5	-	-	35	12	15	16	11	125		A	P	
	7	5	-	-	28	12	f10 g 15.5	12	8	135		A	E	
	7	5	-	-	35	12	8	18	11	125		A	J	
	6	4	-	-	65	12	7	20	16	230		A	JL	
	10x1.5	8x1	-	-	55	55	8	26	9.5	270		A	ML1498	
	10x1.5	8x1	-	-	55	55	8	26	9.5	270		A	MR1499	
	-	5	-	-	35	12	8	18	11	125		A	JB	
	5.5	3.5	-	-	62	12	f14 g 45	12	16.5	202		A	E1205	
	6	-	-	-	60	31	7	23	16	240		A	H	
6.5	4.5	-	-	61	12	7	36	14	185	A	B39			
MGT—N30 MGT—NS30 MGT—NR30 MGT—NB30	-	-	3.3	2.8	43	17	30	25	9	370	MN30	A	S	
	10	6.5	-	-	66	17	15	38	16	380		A	P	
	10	6.5	-	-	45	17	f13 g 28	17	12	395		A	E	
	10	6.5	-	-	52	17	8	28	11	370		A	J	
	8	5	-	-	75	17	8	25	19	470		A	JL	
	15x2	10x1.5	-	-	55	68	10	35	13	520		A	ML1435	
	15x2	10x1.5	-	-	55	68	10	35	13	520		A	MR1395	
	8	5	-	-	65	17	7	41	17.5	355		A	J163	
	7	4.5	-	-	60	62	8	36	16	520		A	L525	

Quotation

\* The capacity is a reference guideline. It depends on the usage conditions. For quantities not displayed here, refer to our MISUMI website for more information.  
\* The weight includes the blade spring.

Order Part Number  
MN3AS  
MN3AP

Days to Ship Quotation

P Price Quotation

■ **High Torque Bolt**

MGT—NWR (Round Type)  
MGT—NWS (Square Type)

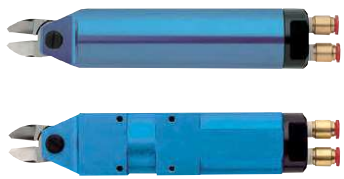
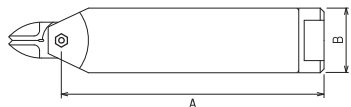
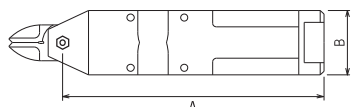
ⓘ The hose fitting is sold separately

■ **Double Action Air Scissors (Round Type without Lever)**

Cutting capacity $\phi$ (mm)			Air consumption (cm <sup>3</sup> /str.)	Weight (g)	Part dimensions (mm)		Part Number	Unit Price 1~9 pcs
Copper	Steel	ABS plastic			A	B		
1.8	1.2	4	116	280	146	$\phi$ 36	MGT—NWR10	Quotation
2.6	2	6.5	230	523	165	$\phi$ 45	MGT—NWR20	
3.3	2.8	9.5	584	980	230.5	$\phi$ 56	MGT—NWR30	

■ **Double Action Air Scissors (Square Type)**

Cutting capacity $\phi$ (mm)			Air consumption (cm <sup>3</sup> /str.)	Weight (g)	Part dimensions (mm)		Part Number	Unit Price 1~9 pcs
Copper	Steel	ABS plastic			A	B		
1	0.5	2	45	116	95	23×20	MGT—NWS1	Quotation
1.8	1.2	4	116	356	146	36×36	MGT—NWS10	
2.6	2	6.5	230	610	165	45×45	MGT—NWS20	
3.3	2.8	9.5	584	1115	230.5	56×56	MGT—NWS30	

ⓘ For quantities not displayed here, refer to our MISUMI website for more information.



Order  
Part Number  
MGT—NWR10  
MGT—NWS1



Days to Ship  
Quotation



Price  
Quotation

■ **Blades for Double Acting Air Nipper**

MNW□□AJ

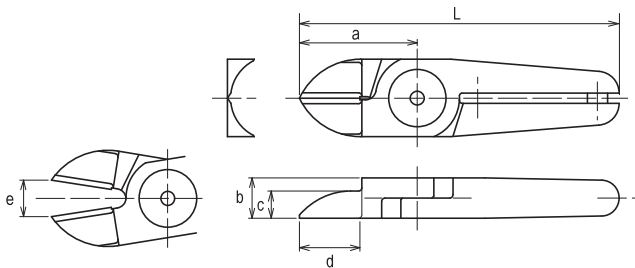
Applicable models	Cutting capacity $\phi$ (mm)				a	b	c	d	e	Weight (g)	Part Number			Unit Price 1~9 pcs
	Soft resin	Hard resin	Copper wire	Iron wire							Body No.	Cutting edge	Shape	
MGT—NWR10 / MGT—NWS10	-	4	-	-	30	9	6	14	5	76	MNW10	A	J	Quotation
MGT—NWR20 / MGT—NWS20	-	6.5	-	-	40	12	6	21.5	8	142	MNW20	A	J	
MGT—NWR30 / MGT—NWS30	-	9.5	-	-	55	17	8	29.5	11	368	MSW30	A	J	

ⓘ For quantities not displayed here, refer to our MISUMI website for more information.



Order  
Part Number  
MNW10



Days to Ship  
Quotation



Price  
Quotation

REMOVAL RELATED PRODUCTS