

# UNI-JOINT PLUGS / HYDRO-CIRCUIT BLOCKS

— HEAT PROOF TYPE —

## Uni-joint plugs

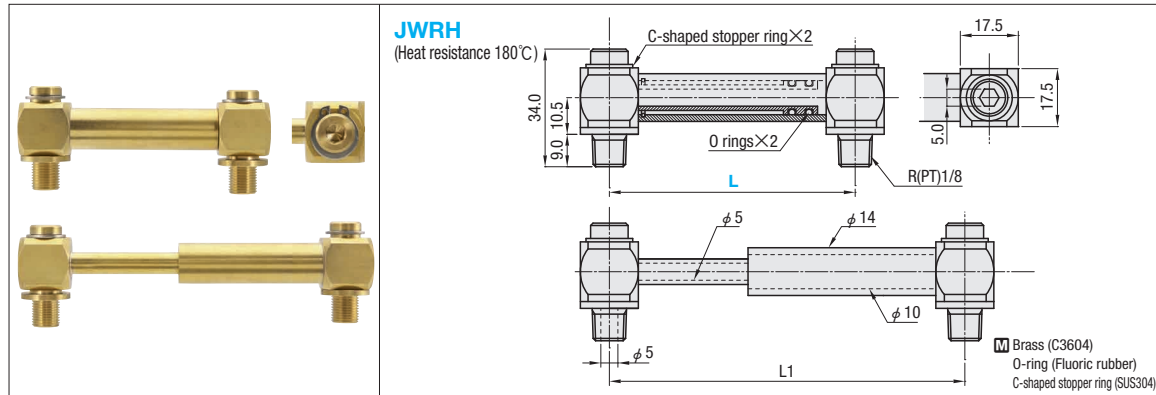

Part Number		L	L1	U/Price 1~9
Type	No.			
JWRH	1	50	65	Quotation
		65	100	

Use in atmospheric pressure 980kPa (10kgf/cm<sup>2</sup>) or lower.

### Characteristics

The length can be adjusted within the L ~ L1 range.  
Heat resistance is 180°C, and it can be used for both cooling water and oil.

### Notes on handling

Install it in a balanced manner. The structure have allowance of about 1mm in height difference between right and left. However, if it is off balance, excessive load is applied onto the body, which may lead to water leakage.

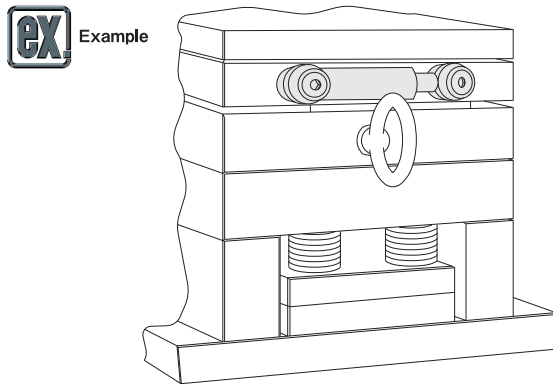

## Hydro-circuit blocks

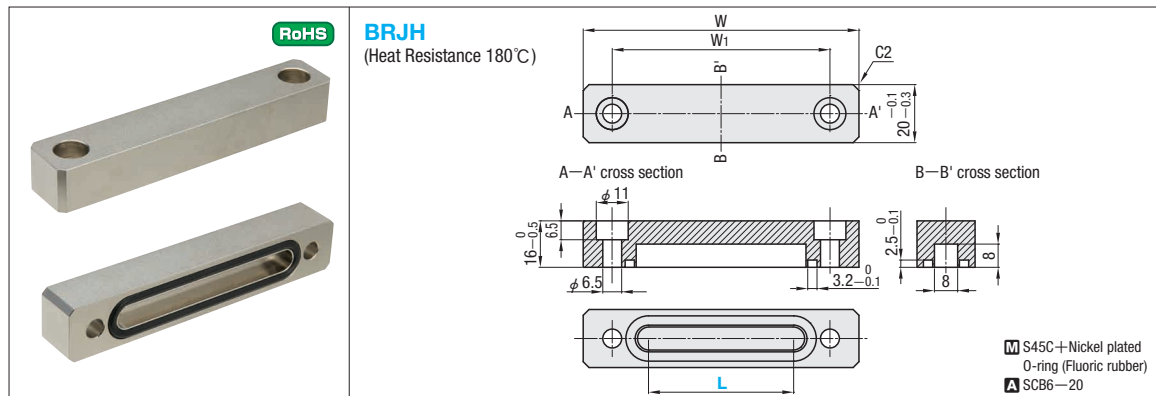

O-ring Size	W	W1	Part Number		U/Price 1~9
			Type	L	
JIS G40	95	75	BRJH	50	Quotation
JIS G60	125	105		80	
JIS G75	145	125		100	

Use in atmospheric pressure 980kPa (10kgf/cm<sup>2</sup>) or lower.

Order Part Number — L  
JWRH1 — 65  
BRJH50

Days to Ship Quotation

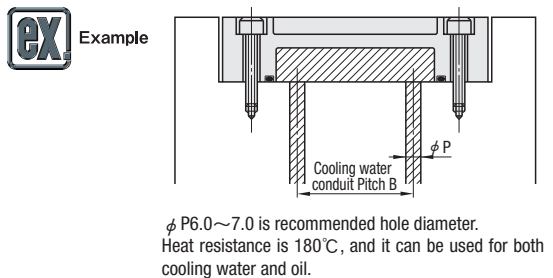

φ P6.0~7.0 is recommended hole diameter.  
Heat resistance is 180°C, and it can be used for both cooling water and oil.

Price Quotation

# SPOT COOLING PIPES

Non JIS material definition is listed on P.1351 - 1352

## SPOT COOLING PIPES

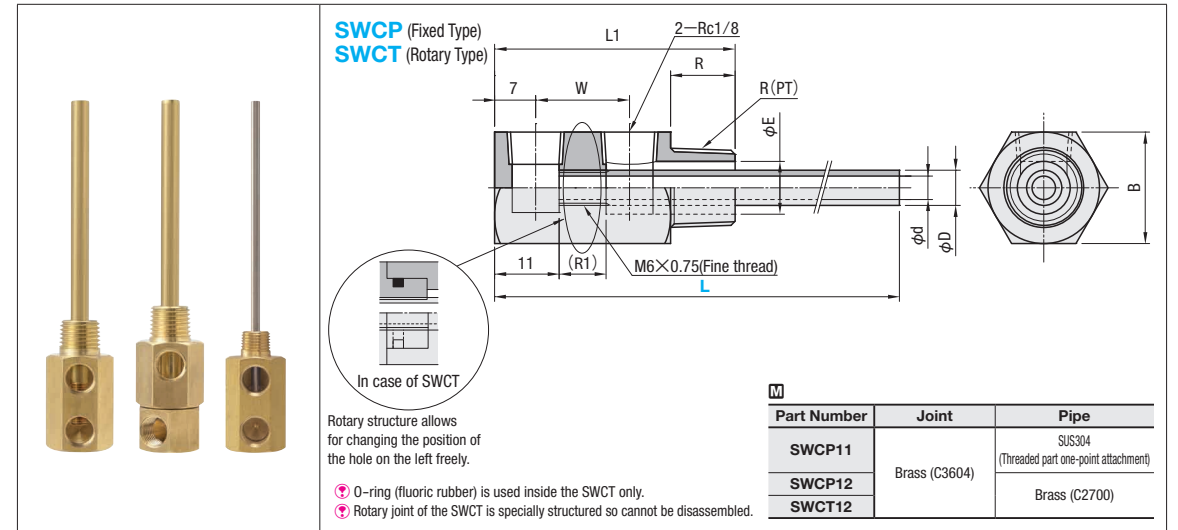

In case of SWCT

Rotary structure allows for changing the position of the hole on the left freely.

- O-ring (fluoric rubber) is used inside the SWCT only.
- Rotary joint of the SWCT is specially structured so cannot be disassembled.

Part Number	Joint	Pipe
SWCP11	Brass (C3604)	SUS304 (Threaded part one-point attachment)
SWCP12		Brass (C2700)
SWCT12		

B	L1	W	ℓ	(ℓ1)	R(PT)	φE	φD	φd	Category	Part Number		L	U/Price 1~9				
										Type	No.		L100	L200	L300	L400	L500
17	38	16	8	8	1/8	6.2	3	2.5	Static type	SWCP	11	300	Quotation				
19	41																

Order Part Number — L  
SWCP12 — 200

Days to Ship Quotation

Price Quotation

Example

### Vertical use

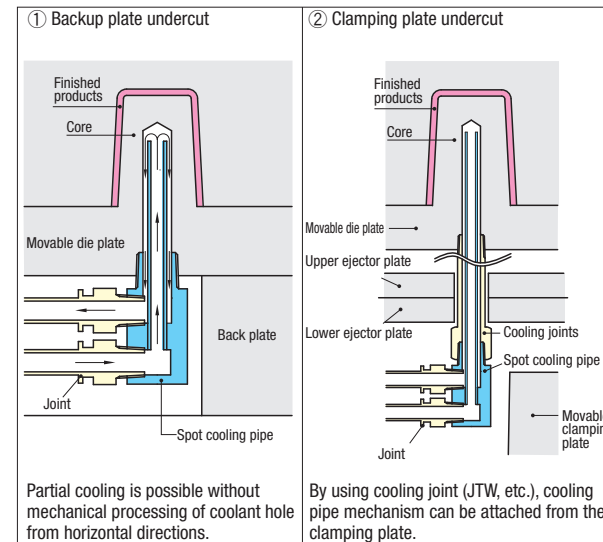

Partial cooling is possible without mechanical processing of coolant hole from horizontal directions.

By using cooling joint (JTW, etc.), cooling pipe mechanism can be attached from the clamping plate.

### Horizontal use

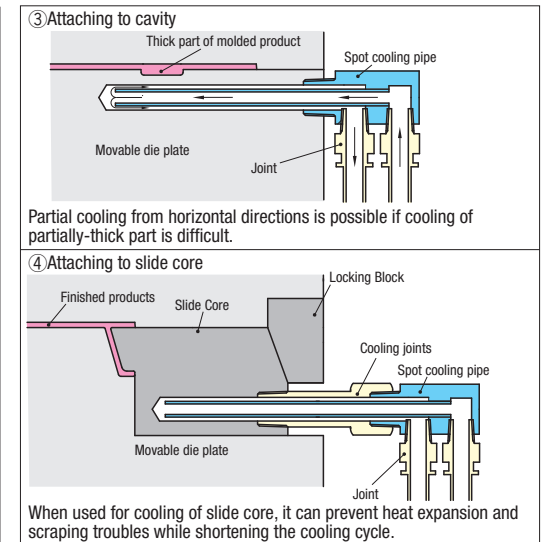

Partial cooling from horizontal directions is possible if cooling of partially-thick part is difficult.

When used for cooling of slide core, it can prevent heat expansion and scraping troubles while shortening the cooling cycle.

Cooling Components  
Joints - Hoses  
Cooling Inside of Mold