

# Holders for Mini Suction Cup / Mini Suction Cups

**Holders for Mini Suction Cup**

**RoHS10**

**MHLDM Threaded**

**MHLDK Threaded**

**MHLD Press Fit**

Ⓞ MHLDK can be used with Vacuum Attachments in P.3555.

**Material:** Body: 303 Stainless Steel  
O-Ring: NBR Nitrile Rubber (JIS B2401 1 Type A)

Part Number Type	No.	L Selection	a Tolerance	M Coarse	D <sub>KB</sub>	P	d	d <sub>1</sub>	L <sub>1</sub>	D <sub>1</sub>	D <sub>2</sub>	W
MHLDM	1.7	5	1.7	M5	5	5	1.2	2	6	9	7	8
MHLDM	2.7			M6	6	6	2.3	3	8	10	8	9
MHLDK	5	15	—	M5	—	5	—	2	6	9	7	8
MHLDK	6			M6	—	6	—	2	8	10	8	9

**Part Number Example**  
Part Number - L  
**MHLDM1.7 - 10**

**Mini Suction Cups**

Type	Material	Hardness	Heat Resistance Temp.	Electrical Resistance
Round	Nitrile Rubber (Black)	Shore A80	-20~150°C	1.0x10 <sup>5</sup> Ω
Square	Silicon Rubber (Black)	Shore A60	-70~200°C	1.0x10 <sup>5</sup> Ω

**Round Type**

**Square Type**

Ⓞ The photograph is enlarged.

Part Number Type	D	C	A	d	H	Applicable Holders
Round Type RBTR SCTR	1	—	—	0.5	1.7	MHLDM
	1.25	—	—	—	—	
	1.5	0.9	—	—	—	
	1.75	1.2	4	—	—	
	2	1.4	—	—	—	
	2.5	1.9	—	—	—	
	3	2.3	—	—	—	
Square Type RBTS SCTS	4	3.2	5	—	1.7	MHLDM
	5	4.2	—	—	—	
	6	4.9	7	—	—	
	7	5.9	—	—	—	
	2	4	—	—	—	
	2.5	5	4	0.4	—	
	3	6	—	—	—	
Square Type	4	8	5	9	1	
	5	10	6	10.5	0.5	
	6	12	6.5	12.5	—	
	7	14	7.5	14.5	—	
	4	8	—	—	—	

Part Number Type	A	B	X	Y	T	d	H	Applicable Holders
Square Type	2	4	—	—	—	—	1.7	MHLDM
	2.5	5	—	—	—	—	—	
	3	6	—	—	—	—	—	
	4	8	5	9	—	1	—	
	5	10	6	10.5	0.5	—	2.7	
6	12	6.5	12.5	—	—	—		
7	14	7.5	14.5	—	—	—		

**Part Number Example**  
Part Number - L  
**RBTR2 RBTS2.5 - 5**

**Application Example**

### What is Mini Suction Cup?

Design to pick up small objects. This can be used for vacuum of packaging equipment, as well as for manufacturing and inspection of semiconductors as with die holders and IC handlers.

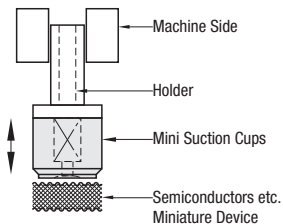
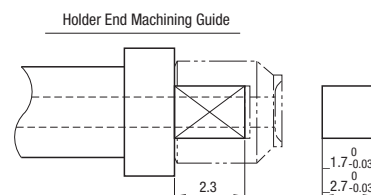

# Vacuum Fittings / Suction Cups

**Vacuum Fittings**

**RoHS10**

Type	Material			Surface Treatment	
	Body	Spring	Nuts	Body	Nuts
SRK	2011 Aluminum Alloy	Spring Steel (ASTM A228)	1018 Carbon Steel	Clear Anodizing	Nickel Plating
SRKN					
SRKNS					

**SRK10**  
1010  
1015

**SRK20**  
2010  
2015

**SRKN10**  
1010  
1015

**SRKN20**  
2010  
2015

**SRKNS40**  
50

Ⓞ Dimensions in ( ) are for SRKNS50.

Part Number Type	No.	Stroke S	L	L <sub>1</sub>	Spring		Applicable Pad
					Spring Constant	Max. Load	
SRK	10	5	40	19	0.030 kgf	0.55 kgf	SRP6-12 SRPF12
	1010	10	45	24	0.025 kgf		
	1015	15	50	29	0.020 kgf		
	20	5	48	20	0.037 kgf		SRP15-40 SRPF20
	2010	10	53	25	0.032 kgf		
2015	15	58	30	0.027 kgf			

Part Number Type	No.	Stroke S	L	L <sub>1</sub>	Spring		Applicable Pads
					Spring Constant	Max. Load	
SRKN	10	5	35	22	0.030 kgf	0.55 kgf	SRP6-12 SRPF12
	1010	10	45	27	0.025 kgf		
	1015	15	55	32	0.020 kgf		
	20	5	39	22	0.037 kgf		SRP15-40 SRPF20
	2010	10	49	27	0.032 kgf		
2015	15	59	32	0.027 kgf			

Type	Part Number		Applicable Pads
	No.		
SRKNS	40		SRPS40
	50		SRPS50

**Suction Cups**

**RoHS10**

Type	Material	Color	Hardness
SRP SRPF SRPS	Silicon Rubber	Sky Blue Translucent	Shore A40 Shore A50

Ⓞ Dimensions in ( ) are for SRPS50.

Part Number Type	No.	Applicable Vacuum Fitting	Mounting
SRP	6	SRK10	Recessed Type
	9	SRK10	
	12	SRKN10	
	15	SRKN10	
	20	SRKN10	
SRPF	20	SRK20	Recessed Type
	30	SRK20	
	40	SRKN20	
	40	SRKN20	
SRPS	40	SRKNS40	Recessed Type
	50	SRKNS50	

Ⓞ Not usable in combination with vacuum fittings on P.3544, 3546, 3548 and 3550.

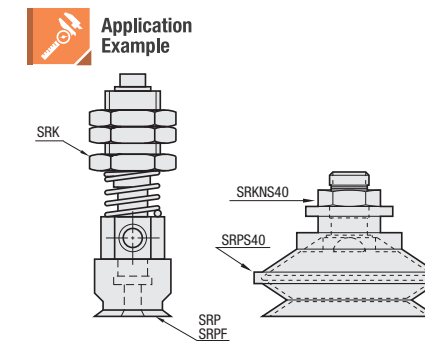

**Part Number Example**  
Part Number  
**SRK10 SRP30**