

# Hydraulic Fittings

Swivel Joints / Straight

**Hydraulic Couplings**

Type	Material	Surface Treatment	Normal Operating Pressure
KCLP__	1018 Carbon Steel or Equivalent	Zinc Plating	20.6 MPa
SKCLP__	304 Stainless Steel	—	
SKCR__	304 Stainless Steel	—	

**KCLPFP SKCLPFP**

**KCLPF SKCLPF**

**KCLPT SKCLPT**

**SKCRGP**

**SKCRGF**

**SKCRCT**

Part Number	T	F	L	l <sub>1</sub>	l <sub>2</sub>	C	E	B
Type	R (PT)	G (PF)					(Wrench Flats)	(Wrench Flats)
<b>KCLPFP</b>								
<b>SKCLPFP</b>								
2	1/4	1/4	52	13	16	24	14	19
3	3/8	3/8	57	15	18	28	20	22
4	1/2	1/2	66	18	20	32	24	27

Part Number	T	F	L	l <sub>1</sub>	l <sub>2</sub>	C	E	B
Type	R (PT)	G (PF)					(Wrench Flats)	(Wrench Flats)
<b>KCLPF</b>								
<b>SKCLPF</b>								
2	1/4	1/4	52	13	13	21	14	19
3	3/8	3/8	57	15	14	24	19	22
4	1/2	1/2	66	18	17	29	24	27

Part Number	T <sub>1</sub>	T <sub>2</sub>	L	l <sub>1</sub>	l <sub>2</sub>	E	B
Type	R (PT)	RC (PT)				(Wrench Flats)	(Wrench Flats)
<b>KCLPT</b>							
<b>SKCLPT</b>							
2	1/4	1/4	53	13	18	19	19
3	3/8	3/8	59	15	18	23	22
4	1/2	1/2	69	18	26	30	27

Part Number	T	F	L	l <sub>1</sub>	B	l <sub>2</sub>	E
Type	R (PT)	G (PF)					(Width Across Flats)
<b>SKCRGP</b>							
2	1/4	1/4	68	13	8	16	19
3	3/8	3/8	72	15	8	18	22
4	1/2	1/2	84	18	10	20	27

Part Number	T	F	L	l <sub>1</sub>	B	l <sub>2</sub>	E
Type	R (PT)	G (PF)					(Wrench Flats)
<b>SKCRGF</b>							
2	1/4	1/4	68	13	8	13	19
3	3/8	3/8	72	15	8	15	22
4	1/2	1/2	82	18	10	18	27

Part Number	T <sub>1</sub>	T <sub>2</sub>	L	A	l <sub>1</sub>	C	E
Type	R (PT)	RC (PT)					(Wrench Flats)
<b>SKCRCT</b>							
2	1/4	1/4	61	39	13	17	19
3	3/8	3/8	66	41	15	19	22
4	1/2	1/2	76	48	18	22	27

**Part Number Example**  
KCLPFP4

**Application Example**

Can be rotated 360° when connected on manifolds, etc.

# Hoses for Food

Standard / Vacuum

**Hoses for Food**

Type			Material		
Hose Only	One End Fitting	Both Ends Fitting	Main Material	Reinforcement	Fittings
HOFW	HOFWK	HOFWR	PVC	Polyester Yarn	Joint Nipples: 316L Stainless Steel
HOGFW	HOGFWK	HOGFWR	PVC	PET Resin	Joint Covers: 304 Stainless Steel

**Hose Body** Hose Length

**One End Fitting** Hose Length (Includes Fittings)

**Both Ends Fitting** Hose Length (Includes Fittings)

**Structure**

**HOFW** (Standard Type)

**HOGFW** (Vacuum Type)

## Swage Fitting Shapes

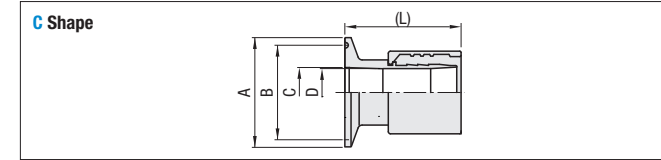

## Swage Fitting Size List

Hose Nominal I.D.	C Shape				
	A	B	C	D	(L)
1S	50.5	43.5	23.0	21.0	56.0
1.5S	50.5	43.5	35.7	33.0	73.0
2S	64.0	56.5	47.8	45.0	75.0

## Hose Dimensions

Hose Nominal I.D.	HOFW HOFW_					
	I.D. (mm)	O.D. (mm)	Thickness (mm)	Min. Bending Radius (mm)	Operating Pressure MPa	Operating Temperature Range °C
6	6	11	2.5	30	0-1.0	-5-70
9	9	15	3	45	0-1.0	
12	12	18	3	65	0-0.8	
15	15	22	3.5	95	0-0.8	
19	19	26	3.5	120	0-0.6	
1S	25	33	4	165	0-0.6	
1.5S	38	48	5	300	0-0.4	
2S	50	62	6	440	0-0.3	

Hose Nominal I.D.	HOGFW HOGFW_						
	I.D. (mm)	O.D. (mm)	Thickness (mm)	Min. Bending Radius (mm)	Operating Pressure Mpa		Operating Temperature Range °C
					50°C	70°C	
15	15	22	3.5	60	-0.1-0.4	-0.1-0.3	-5-70
19	19	26	3.5	80	-0.1-0.4	-0.1-0.3	
1S	25.4	33.4	4	100	-0.1-0.4	-0.1-0.3	
1.5S	38	48	5	150	-0.1-0.3	-0.1-0.2	
2S	50.8	62.8	6	200	-0.1-0.3	-0.1-0.2	

Part Number	Type	Hose Nominal I.D.	Hose Length	L		R	
				0.1 m Increment	Left End Swaged Shape	Right End Swaged Shape	
<b>HOFW HOFWK HOFWR</b>	(Hose Only) (One End Fitting) (Both Ends Fitting)	6	0.5-100.0	—	—	—	
		9					
		12					
		15					
		19					
		1S					
<b>HOGFW HOGFWK HOGFWR</b>	(Hose Only) (One End Fitting) (Both Ends Fitting)	15	0.5-50.0	LC	RC	—	
		19					
		1S					
		1.5S					
		2S					
		2S					

① 1S, 1.5S, 2S not available for HOFWK, HOFWR or HOGFWR.

**Part Number Example**

Part Number	-	Hose Length	-	Shape L	-	Shape R
HOFW6	-	1.5	-		-	
HOFWK1.5S	-	2.0	-	LC	-	
HOFWR2S	-	1.0	-	LC	-	RC

- Features of HOFW**
- Available in high temperature up to 70°C.
  - Superior in flexibility.
  - Excels in transparency and enables the transferred materials to be observed.
  - Conforms to Food Sanitation Laws.

- Features of HOGFW**
- Available in high temperature up to 70°C.
  - Resistant to deformation and excels in shape-retaining property.
  - Excels in transparency and enables the transferred materials to be observed.
  - Conforms to Food Sanitation Laws.

**CAUTION**

- Clean inside the hose.
- Do not soak the hoses or joints in drinking water, food or fluids. Fluid may remain behind the joint and unwanted bacteria may adhere to it.