

# Handles

Folding / with Cap / Cap Nuts / Aluminum Hollow Type

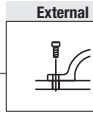

Type	Material	Surface Treatment
UWFASN	1045 Carbon Steel	Chrome Plating
UWFASNS	304 Stainless Steel	Buffed Surface

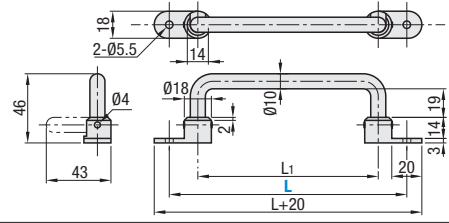

Part Number	Type	L	L <sub>1</sub>	Allowable Load (N)	Mass (g)
UWFASNS Stainless Steel	158	120	550	160	
	180	142	520	180	
	218	180	500	200	

Part Number Example: UWFASN138



Type	Handles			Cap	
	Material	Surface Treatment	Material	Color	
HHDG	ADC12 Aluminum Alloy Cast	Baked Finish	ABS Resin	White	
HHDGS	304 Stainless Steel Equivalent	Buffed Surface	ABS Resin	White	

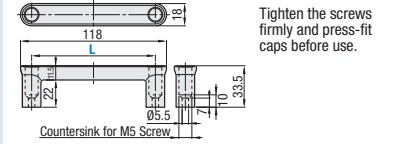

Part Number	Type	L	Mass (g)	Applicable Screws	
				Screws	Quantity
HHDG	HHDGS	100	62	Flathead Screw M5	2

Part Number Example: HHDG100

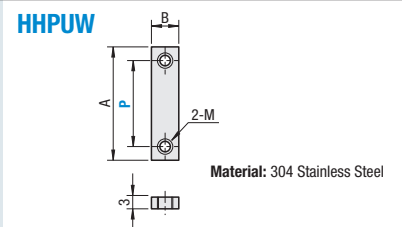

Part Number	Type	P	B	A	M	Handle
		100	12	110	5	HHDG100

Part Number Example: HHPUW100

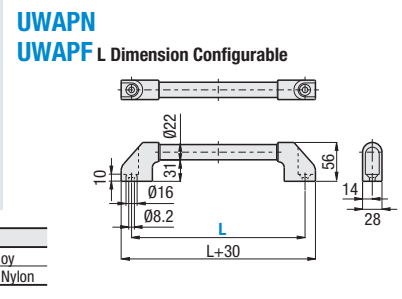

Part Name	Material
Hollow	6063 Aluminum Alloy
Elbow	Glass Fiber Reinforced Nylon

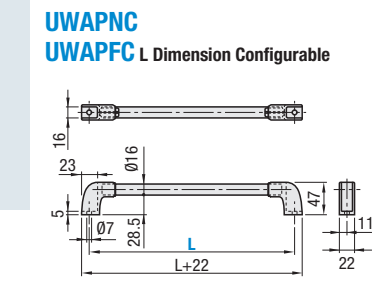

Part Name	Material
Hollow	6063 Aluminum Alloy
Elbow	Polycarbonate

## L Dimension Selectable

Part Number	L	Applicable Screws
UWAPN L Dimension Selectable	150	Countersunk Screws M8
	200	
	250	
	300	
	400	
	500	
	600	

## L Dimension Configurable

Part Number	L 1mm Increment	Applicable Screws
UWAPF L Dimension Configurable	100-150	Countersunk Screws M8
	151-200	
	201-250	
	251-300	
	301-400	
	401-500	
	501-600	

## L Dimension Selectable

Part Number	L	Applicable Screws
UWAPNC L Dimension Selectable	100	Socket Head Cap Screws M6
	150	
	200	
	250	
	300	

## L Dimension Configurable

Part Number	L 1mm Increment	Applicable Screws
UWAPFC L Dimension Configurable	100-150	Socket Head Cap Screws M6
	151-200	
	201-250	
	251-300	

Part Number Example

Part Number: UWAPN150, UWAPFC-185. - is not needed for L Dimension Selectable Type.

# Angled Handles

Welded Round / With Mounting Tabs / With a Plate

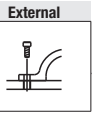

Type	Material	Surface Treatment
UHFSN	12L13 Carbon Steel or Equivalent	Chrome Plating
UHFSNB	12L13 Carbon Steel or Equivalent	Black Oxide
UHFNSS	304 Stainless Steel Equivalent	Buffed Surface

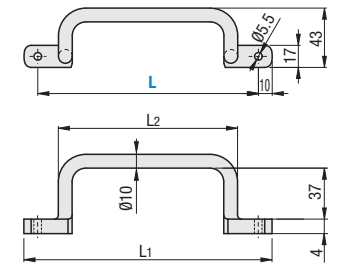

Part Number	Type	L	L <sub>1</sub>	L <sub>2</sub>
UHFSNB Steel	120	140	90	
UHFNSS Stainless Steel	125	145	95	
	160	180	130	
	200	220	170	
	250	270	220	

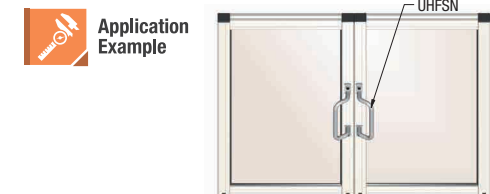

## With Mounting Tabs



Type	Material	Surface Treatment	Accessory			Thread	
			Tab G	Tab S			
			Material	Surface Treatment	Material	Surface Treatment	
UHFNCG	12L13 Carbon Steel or Equivalent	Chrome Plating	Zinc Die Casting	Electrostatic Coating (Silver)	304 Stainless Steel	-	SHFBS5-12 Material: 304 Stainless Steel Equivalent ⊕ 2 screws are included.
UHFNCS	304 Stainless Steel	Buffed Surface					
UHFNCA	Aluminum Alloy	Clear Anodize					

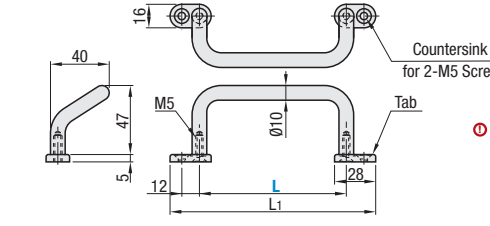

Part Number	Type	L	Tab Selectable	L <sub>1</sub>	Allowable Load (N)	Reference Mass (g)
	66	104	100			
	88	126	114			
UHFNCS Stainless Steel	100	138	122			
	110	148	127			
UHFNCA Aluminum	120	158	134			
	125	163	136			
	160	198	158			

## With a Plate

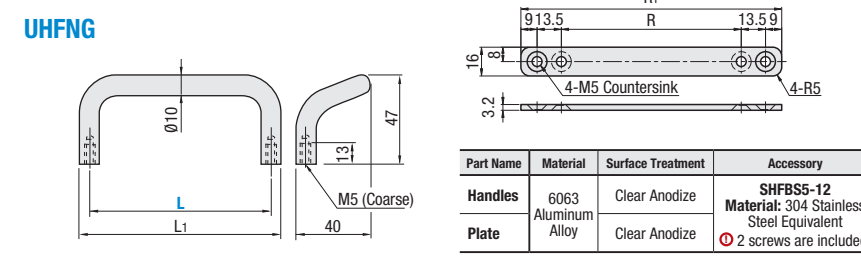
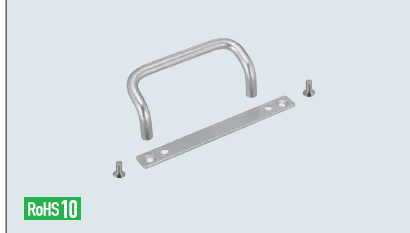

Part Number	Type	L	L <sub>1</sub>	R	R <sub>1</sub>	Reference Mass (g)
		120	130	120	165	52.5
		125	135	125	170	54

The default L dimension will be 100 unless specified.

Part Number Example: UHFSN160, UHFNCG100, UHFNCG120. - M, - G.

Application Example

