

# Aluminum Extrusions (HFS8 Series)

40, 80 mm Square, Other Shapes

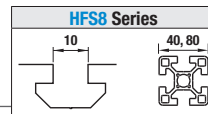

HFS8 Series Aluminum Extrusions – 40, 80 mm Square, Other Shapes

RoHS 10

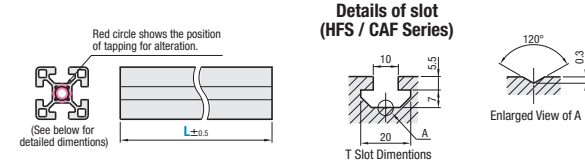

Type		Material	Surface Treatment
Configurable Length	Fixed Length		
HFS_ _A8	KHFS_ _A8	A6N01SS-T5 Aluminum Alloy	Clear Anodize
HFS45TR8	KHFS45TR8		

Ⓢ Cut surface and altered parts are not surface treated.

### Features of Extrusions

Cross Section Shape	HFS Extrusions	Standard cross section shape.
Surface Treatment	Clear Anodize	Common surface treatment.

HFS30A8-40

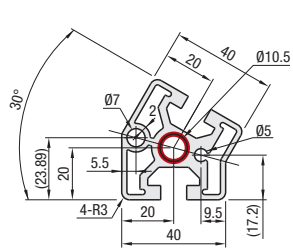

HFS45A8-40

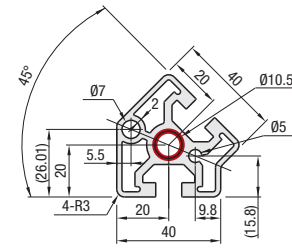

HFS60A8-40

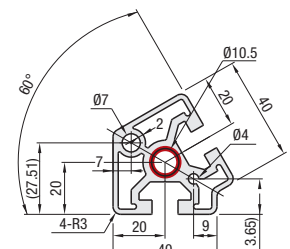

HFS45TR8-40

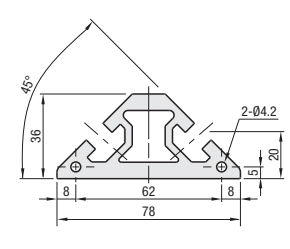

## Configurable Length Extrusions

Part Number	L 0.5 mm Increment	Mass kg/m	Sectional Area mm <sup>2</sup>	Cross Sectional Moment of Inertia mm <sup>4</sup>	
				ix	iy
HFS30A8	40	50-4000	6.94	9.89 x 10 <sup>4</sup>	10.64 x 10 <sup>4</sup>
HFS45A8				9.87 x 10 <sup>4</sup>	10.37 x 10 <sup>4</sup>
HFS60A8				9.99 x 10 <sup>4</sup>	10.53 x 10 <sup>4</sup>
HFS45TR8				12.23 x 10 <sup>4</sup>	38.19 x 10 <sup>4</sup>

## Fixed Length Extrusion (Effective Length 4,000 mm)

Ⓢ Part numbers beginning with the character "K" indicate Fixed Length Extrusion.

Part Number	L mm	Sectional Area mm <sup>2</sup>	Cross Sectional Moment of Inertia mm <sup>4</sup>	
			ix	iy
KHFS30A8	4000	6.94	9.89 x 10 <sup>4</sup>	10.64 x 10 <sup>4</sup>
KHFS45A8			9.87 x 10 <sup>4</sup>	10.37 x 10 <sup>4</sup>
KHFS60A8			9.99 x 10 <sup>4</sup>	10.53 x 10 <sup>4</sup>
KHFS45TR8			12.23 x 10 <sup>4</sup>	38.19 x 10 <sup>4</sup>

Part Number Example: HFS30A8-40 - 800, KHFS30A8-40 - 4000

# Aluminum Extrusions (HFS8 Series)

40, 80 mm Square, Other Shapes

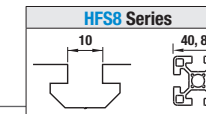

Fixing Parts		Others	
Brackets	Nuts	Joints	Extrusion End Caps
P.2777-2795	P.2796-2803	P.2844-2857	P.2839-2840
			P.2862-2863

Features: Can be used when making angles or making outer surface in radius.

HFS8 Series Aluminum Extrusions – 40, 80 mm Square, Other Shapes

RoHS 10

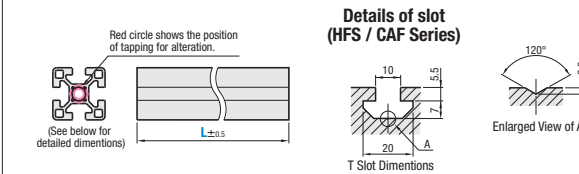

Type		Material	Surface Treatment
Configurable Length	Fixed Length		
HFS8 HFS_ 8	KHFS8 KHFS_ 8	A6N01SS-T5 Aluminum Alloy	Clear Anodize

Ⓢ Cut surface and altered parts are not surface treated.

### Features of Extrusions

Cross Section Shape	HFS Extrusions	Standard cross section shape.
Surface Treatment	Clear Anodize	Common surface treatment.

HFS8-808040

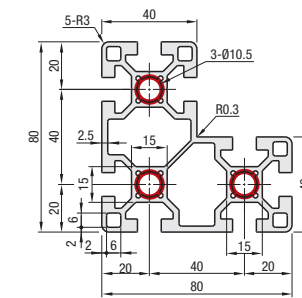

HFSR8-808040

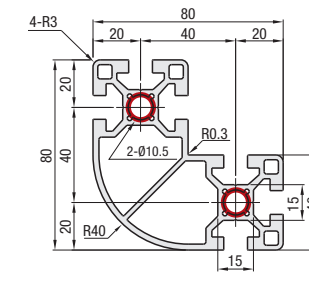

HFSR8-4040

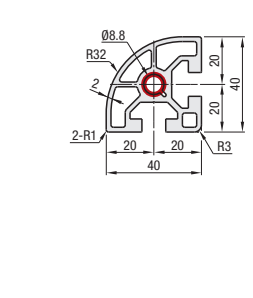

## Configurable Length Extrusions

Part Number	L 0.5 mm Increment	Mass kg/m	Sectional Area mm <sup>2</sup>	Cross Sectional Moment of Inertia mm <sup>4</sup>	
				ix	iy
HFS8	50-4000	4.19	1550	94.2 x 10 <sup>4</sup>	94.2 x 10 <sup>4</sup>
HFSR8		3.61	1339	80.99 x 10 <sup>4</sup>	80.99 x 10 <sup>4</sup>
HFSR8		1.53	564	7.79 x 10 <sup>4</sup>	7.79 x 10 <sup>4</sup>

## Fixed Length Extrusion (Effective Length 4,000 mm)

Ⓢ Part numbers beginning with the character "K" indicate Fixed Length Extrusion.

Part Number	L 0.5 mm Increment	Sectional Area mm <sup>2</sup>	Cross Sectional Moment of Inertia mm <sup>4</sup>	
			ix	iy
KHFS8	4000 (Effective Length)	1550	94.2 x 10 <sup>4</sup>	94.2 x 10 <sup>4</sup>
KHFSR8		564	7.79 x 10 <sup>4</sup>	7.79 x 10 <sup>4</sup>

Part Number Example: HFS8-808040 - 800, KHFSR8-4040 - 4000