

# Hexagon Socket / Hexagon Socket Head Cap Set Screws / Crush Pads

## Soft Tips

### Hexagon Socket Set Screws – Soft Tips

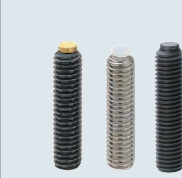

RoHS10

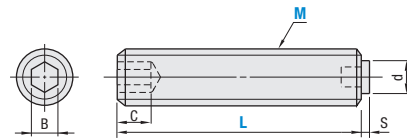

Type	Thread	Surface Treatment	Pad
SBPP	4137 Alloy Steel	Black Oxide	Polyacetal (White)
SBCP			Free-cutting Brass (C36000 Brass BD)
SBCT			Urethane (Shore A70 / Black)
SBPPS	304 Stainless Steel or Equivalent	—	Polyacetal (White)
SBCPS			Free-cutting Brass (C36000 Brass BD)
SBCTS			Urethane (Shore A70 / Black)

Part Number		M (Coarse)	L								S	d	B	C (Min.)
Type	Type		Ⓢ Dimensions in ( ) are only available for SBPP and SBCP											
SBPP	SBCP	3	5	6	8	10	12	16	20		0.5	1.5	1.5	2.0
SBPPS	SBCPS	4		6	8	10	12	16	20		1	2	2	2.5
SBPP	SBCP	5		8	10	12	16	20	25	30	40	50	3.0	
SBPPS	SBCPS	6		8	10	12	16	20	25	30	40	50	3.5	
		8			10	12	16	20	25	30	40	50	5.0	
SBCT		10				12	16	20	25	30	40	50	6.0	
SBCTS		12					16	20	25	30	40	50	8.0	

### L Configurable

Part Number	Available Types					
Type	SBPP	SBCP	SBCT	SBPPS	SBCPS	SBCTS
3	•	•	—	•	•	—
4	•	•	—	•	•	—
5	•	•	•	•	•	•
6	•	•	•	•	•	•
8	•	•	•	•	•	•
10	•	•	•	•	•	•
12	•	•	•	•	•	•

Part Number Example: SBPP10 - L 50

### Hexagon Socket Head Cap Set Screws – Soft Tips



RoHS10

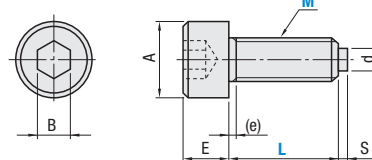

Type	Thread	Surface Treatment	Pad
CBPP	4137 Alloy Steel	Black Oxide	Polyacetal (White)
CBCP			Free-cutting Brass (C36000 Brass BD)
CBPPS	304 Stainless Steel	—	Polyacetal (White)
CBCPS			Free-cutting Brass (C36000 Brass BD)

Part Number		M (Coarse)	L			A	E	S	d	B	(e)
Type	Type		SEPNS	SEPNS	SEPNS						
CBPP	Plastic Pad	3	10	15	20	5.5	3	0.5	1.5	2.5	0.5
CBPPS		4	10	15	20	7	4	1	2	3	0.6
		5	15	20	30	8.5	5	1	3	4	0.6
CBCP	Brass Pad	6	15	20	30	10	6	1	4	5	0.7
CBCPS		8	20	30	40	13	8	2	6	6	1.0

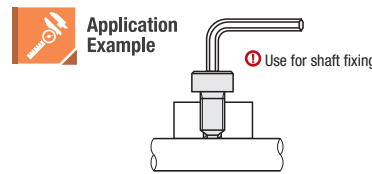

### Crush Pads



SEPN  
SEPN5 Thin  
50/Pkg  
PACK-SEPN  
PACK-SEPN5

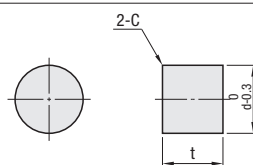

Part Number		Applicable M	d	t		C
Type	Type			SEPNS	SEPNS	
SEPN		*3	2.2	2.0	0.5	0.2*2
SEPN5		*4	3.0	2.5		
PACK-SEPN		*5	3.9	3.0	1.0	
PACK-SEPN 50/Pkg		*6	4.7	3.5		
PACK-SEPN5 50/Pkg		8	6.4	4.5		
		10	8.2	5.5		0.3
		12	9.9	6.5		

\*1 SEPN5 is available for M3-6 only. \*2 For SEPN5, C<0.1.  
\*3 PACK-SEPN5 is available for M3-6 only.

Part Number Example: CBPP3-10 SEPNS PACK-SEPN4

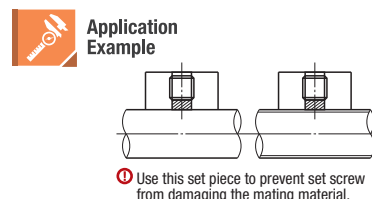

# Hexagon Socket Screws

## Dog Point / Configurable

### Hexagon Socket Screws – Dog Point



RoHS10

### MSSG Hexagon Socket Set Screws

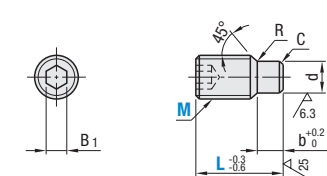

Ⓢ These differ from JIS dog point set screws in dimension of nose portion.  
Ⓢ Use for rough locking of shafts, etc. where continuous load is not imparted to the nose portion.

### CBBG Hexagon Socket Head Cap Screws, Stainless Steel

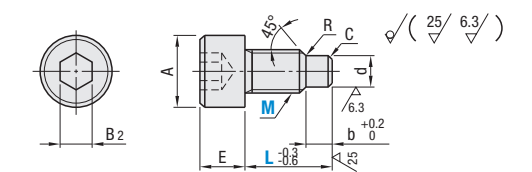

Type	Material	Hardness	Surface Treatment
MSSG	4137 Alloy Steel	45 HRC min.	Black Oxide
CBBG		38-43 HRC min.	
CBBGS	304 Stainless Steel or Equivalent	—	—

Part Number		M (Coarse)	L						B1	B2	A	E	d		b	C	R	Available Types		
Type	Type		Ⓢ Dimensions in ( ) are only available for SBPP and SBCP										Reference Dim.	Tolerance				MSSG	CBBG	CBBGS
MSSG		4	12	16	20	25	30	2	3	7	4	3	-0.1	3	0.3	0.5				
CBBG		5	12	16	20	25	30	2.5	4	8.5	5	-0.2	4	0.3	0.5					
CBBGS		6	12	16	20	25	30	3	5	10	6	-0.1	5	0.5	1					
		8	16	20	25	30	35	4	6	13	8	-0.1	6	0.5	1					
		10	20	25	30	35	40	5	8	16	10	-0.3	8	0.5	1					

### Hexagon Socket Screws – Dog Point / Configurable



RoHS10

### FMSS Hexagon Socket Set Screws

### FMSSGS Hexagon Socket Set Screws, Stainless Steel

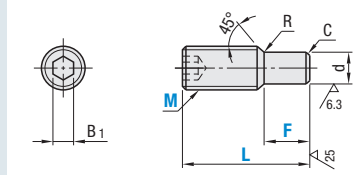

Ⓢ Use for rough locking of shafts, etc. where continuous load is not imparted to the nose portion.  
Ⓢ These differ from JIS dog point set screws in dimension of nose portion.

### FCBBG Hexagon Socket Head Cap Screws, Stainless Steel

### FCBBGS Hexagon Socket Head Cap Screws, Stainless Steel

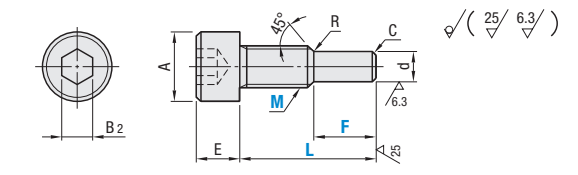

Type	Material	Hardness	Surface Treatment
FMSSG	4137 Alloy Steel or Equivalent	45 HRC min.	Black Oxide
FCBBG		38-43 HRC min.	
FMSSGS FCBBGS	304 Stainless Steel or Equivalent	—	—

Part Number		M (Coarse)	L		F	B1	B2	A	E	d		C	R
Type	Type		FMSSG / FMSSGS	FCBBG / FCBBGS						1 mm Increment	Reference Dim.		
FMSSG		4	—	12-25	Ⓢ 2-30 Ⓢ 10≤L-F	—	3	7	4	3	-0.1	0.3	0.5
FMSSGS		5	12-25	12-25		2.5	4	8.5	5	4	-0.2	0.3	0.5
FCBBG		6	12-40	12-30		3	5	10	6	6	-0.1	0.5	1
FCBBGS		8	12-50	12-35		4	6	13	8	8	-0.1	0.5	1
		10	12-50	12-40		5	8	16	10	10	-0.3	0.5	1

Ⓢ FMSSG and FMSSGS are not available for M4.

Part Number Example: MSSG5 - L 16  
FMSSG6 - L 50 - F 20

Part Number Alterations: CBBG8 - L 20 - RC / RS

### Application Example

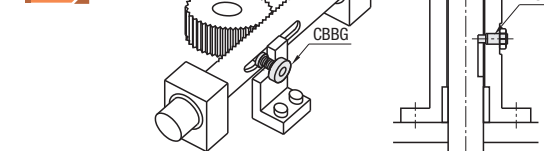

Alteration	Tip R Machining	Undercut
	RC	RS
Code	RC	RS
Spec.	Adds Tip R Processing to M the tip of a nose portion. 4 Ⓢ Applicable only to MSSG 5 and CBBG. Ordering Code: RC	Adds an undercut below the head of CBBG. Ⓢ Applicable to CBBG, FCBBG and FCBBGS only. Ordering Code: RS