

# Flanged Idlers with Teeth

S2M, S3M Type

Ⓢ Tensioners can be selected from P.1530-1531 Ⓢ Idler shafts (cantilever shafts) can be selected from P.912

## Flanged Idlers with Teeth - S2M, S3M Type



Type		Material		Surface Treatment	
Center Bearing	Both Sides Bearing	Main Body	Flange	Bearing	
AHTF	AHTFW	Ultra Duralumin-Based Aluminum Alloy	Aluminum Alloy	Steel	Clear Anodize
—	KHTFW				Hard Clear Anodize*
NHTF	NHTFW	304 Stainless Steel	—	Stainless Steel	Electroless Nickel Plating
SHTF	—				—

\*Hard Anodize Treatment: Film Hardness 300 HV min.

### Center Bearing Type

Bearing 1 Pc.

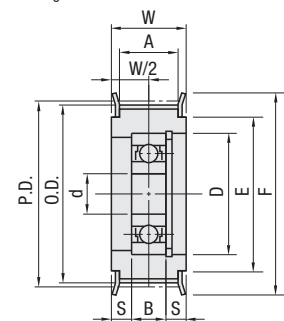

Bearing 2 Pcs.

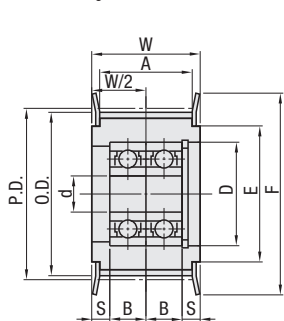

### Both Sides Bearing Type

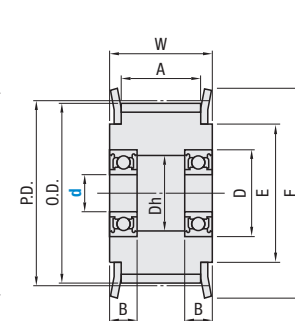

Ⓢ Bearings are press-fitted.

\*Bearing Accuracy JIS B1514 Class 0

## S2M Type (Center Bearing Type)

Type	Part Number		Shaft Diameter d	P.D.	O.D.	F	E	A	W	S	Bearing Dimensions					
	Teeth	Applicable Belt									No.	D	B			
AHTF	40	S2M040	5	25.46	24.96	30	20	5	9	2.5	695ZZx1	13	4			
		S2M060	6											696ZZx1	15	5
		S2M100	7													
	48	S2M040	6	30.56	30.05	35	25	5	9	2	696ZZx1	15	5			
		S2M060	7											696ZZx1	15	5
		S2M100	8													
	50	S2M040	6	31.83	31.32	35	25	5	9	2	696ZZx1	15	5			
		S2M060	7											698ZZx1	19	6
		S2M100	8													
	60	S2M040	10	38.20	37.69	44	32	5	9	1.5	6900ZZx1	22	6			
		S2M060	7											6900ZZx1	22	6
		S2M100	7													

## S3M Type (Both Sides Bearing Type)

Type	Part Number		Shaft Diameter d	P.D.	O.D.	F	E	A	W	Dh	Bearing Dimensions												
	Teeth	Applicable Belt									No.	D	B										
AHTFW NHTFW	20	S2M040	3	12.73	12.22	16	10	5	9	5	673ZZx2	6	2.5										
		S2M060	4											674ZZx2	7	2.5							
		S2M100	11																				
	30	S2M040	3	19.01	18.59	22	14	5	9	5	673ZZx2	6	2.5										
		S2M060	4											674ZZx2	7	2.5							
		S2M100	11																				
	32	S2M040	3	20.37	19.86	25	16	5	9	5	673ZZx2	6	2.5										
		S2M060	4											694ZZx2	11	4							
		S2M100	11																				
	36	S2M040	4	22.92	22.41	28	18	5	9	6	674ZZx2	7	2.5										
		S2M060	5											695ZZx2	13	4							
		S2M100	11																				
40	S2M040	4	25.46	24.96	30	20	5	9	6	674ZZx2	7	2.5											
	S2M060	5											695ZZx2	13	4								
	S2M100	11																					
48	S2M100	8	30.56	30.05	35	25	11	15	16.5	698ZZx2	19	6											
	50	S2M100											8	31.83	31.32	35	25	11	15	16.5	698ZZx2	19	6
		60											S2M100										

**Part Number Example**

Center Bearing Type			Both Sides Bearing Type			
Type	Teeth	Applicable Belt	Type	Teeth	Applicable Belt	d
AHTF	40	S2M060	AHTFW	32	S3M100	8

# Flanged Idlers with Teeth

S2M, S3M Type, continued

## S3M Type (Center Bearing Type)

Type	Part Number		Shaft Diameter d	P.D.	O.D.	F	E	A	W	S	Bearing Dimensions			Available Types			
	Teeth	Applicable Belt									No.	D	B	AATF	BATF	MATF	
AHTF NHTF SHTF	20	S3M060	5	19.10	18.34	22	14	7	11	3	685ZZx1	11	5	•	•	—	
		S3M100	11														2.5
	24	S3M060	5	22.92	22.16	25	16	7	11	3.5	695ZZx1	13	4	•	•	•	•
		S3M100	11														
	25	S3M060	5	23.87	23.11	28	18	7	11	3.5	695ZZx1	13	4	•	•	•	•
		S3M100	11														
	26	S3M060	6	24.83	24.07	28	18	7	11	3	696ZZx1	15	5	•	•	•	•
		S3M100	7														
	28	S3M060	6	26.74	25.98	30	20	7	11	3	696ZZx1	15	5	•	•	•	•
		S3M100	7														
	30	S3M060	6	28.65	27.89	32	23	7	11	3	696ZZx1	15	5	•	•	•	•
		S3M100	11														
32	S3M060	8	30.56	29.80	35	25	7	11	2.5	698ZZx1	19	6	•	•	•	•	
	S3M100	11															15
36	S3M060	8	34.38	33.62	40	28	7	11	2.5	698ZZx1	19	6	•	•	•	•	
	S3M100	11															15
40	S3M060	10	38.20	37.44	44	32	7	11	2.5	6900ZZx1	22	6	•	•	•	•	
	S3M100	10															42.02
44	S3M060	10	42.02	41.25	48	36	7	11	2.5	6900ZZx1	22	6	•	•	•	•	
	S3M100	10															45.84
48	S3M060	10	45.84	45.07	50	38	7	11	2.5	6900ZZx1	22	6	•	•	•	•	
	S3M100	10															47.75
50	S3M060	10	47.75	46.98	52	40	7	11	2.5	6900ZZx1	22	6	•	•	•	•	
	S3M100	10															57.30

## S3M Type (Both Sides Bearing Type)

Type	Part Number		Shaft Diameter d	P.D.	O.D.	F	E	A	W	Dh	Bearing Dimensions							
	Teeth	Applicable Belt									No.	D	B					
AHTFW KHTFW	20	S3M060	3	19.10	18.34	22	14	7	11	5	673ZZx2	6	2.5					
		S3M100	4											674ZZx2	7	2.5		
		S3M150	5														17	21
	24	S3M060	5	22.92	22.16	25	16	7	11	11	11	695ZZx2	13	4				
		S3M100	11												15	695ZZx2	13	4
		S3M150	17												21	695ZZx2	13	4
	25	S3M100	6	23.87	23.11	28	18	11	15	13	13	696ZZx2	15	5				
		S3M150	17												21	696ZZx2	15	5
		S3M100	11												15	696ZZx2	15	5
	26	S3M100	6	24.83	24.07	28	18	11	15	13	13	696ZZx2	15	5				
		S3M150	17												21	696ZZx2	15	5
		S3M100	11												15	696ZZx2	15	5
28	S3M100	6	26.74	25.98	30	20	11	15	13	13	696ZZx2	15	5					
	S3M150	17												21	696ZZx2	15	5	
	S3M100	11												15	696ZZx2	15	5	
30	S3M100	6	28.65	27.89	32	23	11	15	13	13	696ZZx2	15	5					
	S3M150	17												21	696ZZx2	15	5	
	S3M100	11												15	696ZZx2	15	5	
32	S3M100	8	30.56	29.80	35	25	11	15	16.5	16.5	698ZZx2	19	6					
	S3M150	17												21	698ZZx2	19	6	
	S3M100	11												15	698ZZx2	19	6	
36	S3M100	10	34.38	33.62	40	28	11	15	19.5	19.5	6900ZZx2	22	6					
	S3M150	17												21	6900ZZx2	22	6	
	S3M100	11												15	6900ZZx2	22	6	
40	S3M100	10	38.20	37.44	44	32	11	15	19.5	19.5	6900ZZx2	22	6					
	S3M150	17												21	6900ZZx2	22	6	
	S3M100	11												15	6900ZZx2	22	6	
44	S3M100	10	42.02	41.25	48	36	11	15	19.5	19.5	6900ZZx2	22	6					
	S3M150	17												21	6900ZZx2	22	6	
	S3M100	11												15	6900ZZx2	22	6	
48	S3M100	10	45.84	45.07	50	38	11	15	19.5	19.5	6900ZZx2	22	6					
	S3M150	17												21	6900ZZx2	22	6	
	S3M100	11												15	6900ZZx2	22	6	
50	S3M100	10	47.75	46.98	52	40	11	15	19.5	19.5	6900ZZx2	22	6					
	S3M150	17												21	6900ZZx2	22	6	
	S3M100	11												15	6900ZZx2	22	6	
60	S3M100	10	57.30	56.53	61	46	11	15	19.5	19								