

Large Digital Position Indicators

Standard Spindle Large / Front Spindle Large / Vertical Spindle Large Types

Large counters are easy to see even with handles mounted and the Zero Set function resets the zero instantly.

Type		Cover		Backboards		Sleeves		Accessory	
5-Digit Type	Material	Color	Material	Material	Surface Treatment	Material	Surface Treatment	Set Screws (Black) (4137 Alloy Steel)	Cushion Sheets (Black) (Polyethylene Foam)
DPLR / DPLL	Nylon	Orange	Polyphenylene Ether	1215	Black Oxide	1215	Black Oxide	Set Screws (Black) (4137 Alloy Steel)	Cushion Sheets (Black) (Polyethylene Foam)
DSLRL / DSLL		Silver							



RoHS 10

Wrench Hole for Reset

Hex Socket Set Screw M5x0.8

Cushion Sheet

Recommended Tolerance of Mating Shaft: h7

To set the zero, remove the cap and turn slowly with a hex wrench (3 mm hex)

Operating Temperature: -10°C-60°C

Type		Cover		Backboards		Sleeves		Accessory	
5-Digit Type	Material	Color	Material	Material	Surface Treatment	Material	Surface Treatment	Set Screws (Black) (4137 Alloy Steel)	Cushion Sheets (Black) (Polyethylene Foam)
DPRLR, DPRL	Nylon	Orange	Polyphenylene Ether	1215	Black Oxide	1215	Black Oxide	Set Screws (Black) (4137 Alloy Steel)	Cushion Sheets (Black) (Polyethylene Foam)
DSRLR, DSRL		Silver							



RoHS 10

Wrench Hole for Reset

Hex Socket Set Screw M5x0.8

Cushion Sheet

Recommended Tolerance of Mating Shaft: h7

To set the zero, remove the cap and turn slowly with a hex wrench (3 mm hex)

Operating Temperature: -10°C-60°C

Type		Cover		Backboards		Sleeves		Accessory	
5-Digit Type	Material	Color	Material	Material	Surface Treatment	Material	Surface Treatment	Set Screws (Black) (4137 Alloy Steel)	Cushion Sheets (Black) (Polyethylene Foam)
DPZLR, DPZL	Nylon	Orange	Polyphenylene Ether	1215	Black Oxide	1215	Black Oxide	Set Screws (Black) (4137 Alloy Steel)	Cushion Sheets (Black) (Polyethylene Foam)
DSZLR, DSZL		Silver							



RoHS 10

Wrench Hole for Reset

Hex Socket Set Screw M5x0.8

Cushion Sheet

Recommended Tolerance of Mating Shaft: h7

To set the zero, remove the cap and turn slowly with a hex wrench (3 mm hex)

Operating Temperature: -10°C-60°C

Part Number		Spindle Pitch	Count Increment per Revolution	Maximum Revolution Frequency (rpm)	Mass (g)
Type	Color				
DPL	Orange	3	0003.0	100	100
DSL	Silver	4	0004.0	75	
DPR	Orange	5	0005.0	60	
DSR	Silver	6	0006.0	50	
DPZ	Orange	3	0003.0	100	
DSZ	Silver	4	0004.0	75	

Part Number Example	Part Number
DPLR4	DPLR4
DSLRL5	DSLRL5
DPZLR3	DPZLR3

For Zero Setting procedures, please see P.843.

Features

Use with a lead screw with the same pitch. Display number and pitch number will be the same.

Counter Indication for both clockwise and counterclockwise rotation. The counter instantly indicates all zeros with Wrench Hole for Reset.

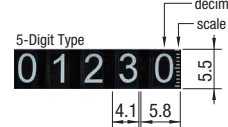

Application Example

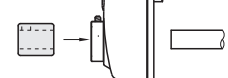

Collar as an alteration enables screw shafts other than 20 mm diameter (lead screws and slide screws, etc.) to be adapted to the indicators.

Part Number Alterations

Alteration	Code	Spec.
Includes an Adapter Collar in the set Indicator Collar Details	CSE	Shafts less than 20 mm O.D. are used with a collar attached. Please select a collar with an I.D. of required shaft diameter, and order as an alteration. Ordering Code: DPLR3-CSE14 Add the needed collar "d" after the Indicator model number.
Collar dimension 10.....	CSE10	
Collar dimension 12.....	CSE12	
Collar dimension 14.....	CSE14	
Collar dimension 15.....	CSE15	
Collar dimension 16.....	CSE16	
Collar dimension 17.....	CSE17	

Material: 1045 Carbon Steel Equivalent Surface Treatment: Black Oxide

d	Mass (g)
10	37
12	31
14	25
15	21
16	17
17	15

Compact Digital Position Indicators

Front Spindle Compact / Standard Spindle Compact / Vertical Spindle Compact

Type		Cover		Backboards		Sleeves		Accessory	
4-Digit Type	5-Digit Type	Material	Color	Material	Material	Material	Surface Treatment	Set Screws (Black) (4137 Alloy Steel)	Cushion Sheets (Black) (Polyethylene Foam)
DPMLR, DPML	—	Nylon	Orange	Polyphenylene Ether	1215	Carbon Steel	Black Oxide	Set Screws (Black) (4137 Alloy Steel)	Cushion Sheets (Black) (Polyethylene Foam)
DSMLR, DSML			Silver						



RoHS 10

Hexagon Socket Set Screw M4x0.7

Cushion Sheet

Recommended Tolerance of Mating Shaft: h7

Operating Environment Temp: -10°C-60°C

Type		Cover		Backboards		Sleeves		Accessory	
4-Digit Type	5-Digit Type	Material	Color	Material	Material	Material	Surface Treatment	Set Screws (Black) (4137 Alloy Steel)	Cushion Sheets (Black) (Polyethylene Foam)
DPNLR, DPNL	—	Nylon	Orange	Polyphenylene Ether	1215	Carbon Steel	Black Oxide	Set Screws (Black) (4137 Alloy Steel)	Cushion Sheets (Black) (Polyethylene Foam)
DSNLR, DSNL			Silver						



RoHS 10

Hexagon Socket Set Screw M4x0.7

Cushion Sheet

Recommended Tolerance of Mating Shaft: h7

Operating Environment Temp: -10°C-60°C

Type		Cover		Backboards		Sleeves		Accessory	
4-Digit Type	5-Digit Type	Material	Color	Material	Material	Material	Surface Treatment	Set Screws (Black) (4137 Alloy Steel)	Cushion Sheets (Black) (Polyethylene Foam)
DPTRL, DPTR	—	Nylon	Orange	Polyphenylene Ether	1215	Carbon Steel	Black Oxide	Set Screws (Black) (4137 Alloy Steel)	Cushion Sheets (Black) (Polyethylene Foam)
DSTRL, DSTL			Silver						



RoHS 10

Hexagon Socket Set Screw M4x0.7

Cushion Sheet

Recommended Tolerance of Mating Shaft: h7

Operating Environment Temp: -10°C-60°C

Part Number		Spindle Pitch	Count Increment per Revolution		Maximum Revolution Frequency (rpm)	Mass (g)
Type	Color		4-Digit	5-Digit		
DPM	Orange	2	002.0	0002.0	150	44
DPN	Silver	3	003.0	0003.0	100	
DPT	Orange	4	004.0	0004.0	75	
DPT	Silver	5	005.0	0005.0	60	
DPT	Orange	6	006.0	0006.0	50	
DPT	Silver	6	006.0	0006.0	50	

Part Number Alterations

Alteration	Code	Spec.
Includes an Adapter Collar in the set Indicator Collar Details	CSE	Shafts whose O.D. is less than 14 mm are used with a collar attached. Please select a collar with an I.D. of required shaft diameter, and order as an alteration. Ordering Code: DPLR2-CSE 8 Add the needed collar "d" after the Indicator model number.
Collar dimension 6.....	CSE6	
Collar dimension 8.....	CSE8	
Collar dimension 10.....	CSE10	
Collar dimension 12.....	CSE12	

Material: 1045 Carbon Steel Equivalent Surface Treatment: Black Oxide

d	Mass (g)
6	16
8	14
10	9
12	5

Part Number Example	Part Number
DPNFR4	DPNFR4
DSML5	DSML5
DPTR2	DPTR2

Features

Use with a lead screw with the same pitch. Display number and pitch number will be the same.

Counter Indication for both clockwise and counterclockwise rotation.

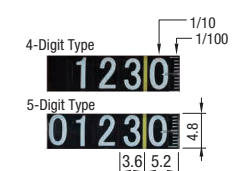

The leftmost position is blank on the 4-digit counter.

Application Example

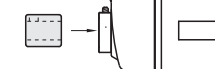

Attaching a collar enables screw shafts other than 14 mm diameter (lead screws and slide screws, etc.) to be adapted to the indicators.