

Low Friction Cable Carrier

Low Noise

Low Friction Cable Carrier – Low Noise

RoHS 10

Type	Material	Main Body		Mounting Bracket	
		Material	Surface Treatment	Material	Surface Treatment
Cable Carrier + Mounting Bracket	MPSPS	Nylon 6+Glass Fiber 30% (Operating Temperature -10~90°C) Flammability Standard UL94-HB Equivalent	Low Carbon Steel	Trivalent Bright Chromate Plating	

External Dimension Diagram

Cross-Section

The above is a drawing of Cable Carrier assembled with 10 links and mounting brackets.

Moving Ends

Fixed Ends

Cautions

- ⚠ Cable Carrier (10 Links and 1 Link) and mounting brackets are not assembled together at the time of delivery. Link connection and brackets are required for use.
- ⚠ Install the mounting bracket fixed end on the lower side, and moving end on the upper side (Refer to Positional Relationship in External Dimension Diagram).
- ⚠ Mounting bracket shape varies depending on size.

Part Number	Type	Bending Radius	No. of Links	Mounting Direction	Cable Carrier Dimensions										Mounting Dimensions		H (Mounting Height)	H ₁	HF (Required Physical Height)	K (Arc + Margin)	Weight per Meter (kg) (Reference)
					A	B	C	W	P	ℓ	F	T	J	N	P ₁	P ₂					
MPSPS Cable Carrier + Mounting Brackets	1520	30	7-55	S (Common to Mounting on Outer and Inner Circumference)	15	21	20	32	25	30	20	10	10	4.5	15 (12)	27.2 (24.4)	81	60	100	154.2	0.36
		50	9-57		20	26	35	47	32	35	26	14	15	7	27 (24)	44 (40)	116	90	140	211.3	
		45	7-45		25	35	50	65	36	55	40	24	20	7	40 (35.4)	60.6 (56)	135	100	160	257	
		50	8-51		25	35	50	65	36	55	40	24	20	7	75 (70.4)	95.6 (91)	185	150	210	333.5	
		75	10-53		25	35	85	100	43.5	55	40	24	20	7	75 (70.4)	95.6 (91)	185	150	210	335.5	
		100	12-55		25	35	85	100	43.5	55	40	24	20	7	75 (70.4)	95.6 (91)	185	150	210	335.5	
	2035	60	8-49		25	35	85	100	43.5	55	40	24	20	7	70 (65)	93.6 (88)	250	200	280	440	1.05
		75	9-50		35	50	80	101	62.5	65	40	24	20	7	70 (65)	93.6 (88)	350	300	380	597	
		75	11-52		35	50	80	101	62.5	65	40	24	20	7	70 (65)	93.6 (88)	350	300	380	597	
		100	8-43		35	50	80	101	62.5	65	40	24	20	7	70 (65)	93.6 (88)	350	300	380	597	
		100	10-45		35	50	80	101	62.5	65	40	24	20	7	70 (65)	93.6 (88)	350	300	380	597	
		150	10-45		35	50	80	101	62.5	65	40	24	20	7	70 (65)	93.6 (88)	350	300	380	597	

⚠ * () indicates Fixed End dimensions.

Part Number	Type	No.	Bending Radius	No. of Links	Mounting Direction
MPSPS Cable Carrier + Mounting Brackets	1520	30	7-55	S (Common to Mounting on Outer and Inner Circumference)	S
		50	9-57		
		45	7-45		
		50	8-51		
		75	10-53		
		100	12-55		
	2035	60	8-49		
		75	9-50		
		100	11-52		
		100	8-43		
		100	10-45		
		150	10-45		

Mounting Direction

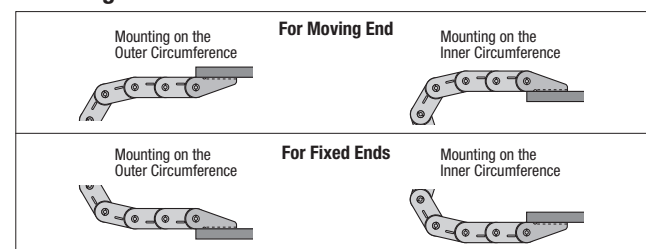

⚠ In the case of new designs, there may be a possibility that carrier links run short. It is recommended that links are selected longer by one or two links, and are adjusted (removed) at the time of installing (removing) device.

Cautions on Model Selection

⚠ A Cable Carrier and suitable Mounting Brackets (Moving Ends x 1 set, Fixed Ends x 1 set) are in a set.

Part Number Example

Part Number - Bending Radius - Number of Links - Mounting Direction

MPSPS3580 - 100 - 18 - S

Flap Opening / Closing

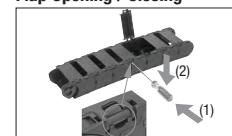

To open the flap, insert a flat head screw driver into the side window and pry. To close the flap, push down.

Link Connection

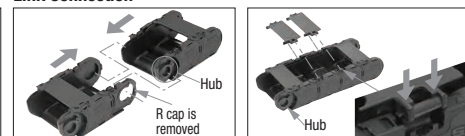

Open flaps and remove the R cap of the connecting links. Insert the hub side first, then push the entire links from both sides. Confirm the hub connection, place back the removed R cap to fit the groove on the cable carrier, and restore flaps.

Cable Carrier Supporter Channels

Cable Carrier Supporter Channels

RoHS 10

Type	Mounting Hole	Material	Plate Thickness (mm)	Surface Treatment	Machining Conditions 4+N≤Y≤A-(14+N) 4+N≤X≤B-(10+N)
CBC	Not Provided	SECC	1.6	Electrolytic Zinc Plating	
CBCS		430 Stainless Steel	1.5	—	
C BCH	Provided	SECC	1.6	Electrolytic Zinc Plating	
CBCSH		430 Stainless Steel	1.5	—	

No Mounting Hole

With Mounting Hole

Part Number	A	B	H	X	Y	N
Type	5 mm Increment		10 20	1mm Increment		Selectable (Hole Dia.)
CBC CBCS C BCH CBCSH	40	200-1000		10 20	10-984	10-20
	50		10-30			
	60		10-40			
	70		10-50			
	80		10-60			
	90		10-70			
120	10-100					

Part Number Example

Part Number - A - B - H - X - Y - N

C BCH - A70 - B800 - H10 - X700 - Y30 - N11

Application Example

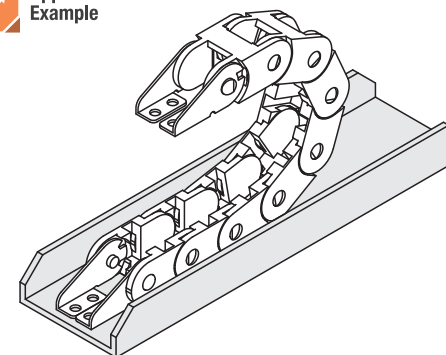

Part Number Alterations

Part Number - A - B - H - X - Y - N - (TC)

C BCH - A70 - B800 - H10 - X700 - Y30 - N11 - TC - E70 - F30 - G30 - NA5

Alteration	Code	Spec.
	TC	Applicable to With Mounting Hole Type. Adds cable carrier mounting holes. Specify E/F/G in 1 mm increment. Select NA from 5 / 6 / 7 Order Code: TC-E30-F30-G40-NA5 Machining Conditions 4+NA≤G≤A-(14+NA) 4+NAX2≤F≤B-(10+NAX2) 4+NA≤E≤B-(F+4+NA)