

Miniature Linear Guides (Wide Standard Blocks)

Light Preload / Slight Clearance

Similar Products Comparison Points

Wide Block Type of MISUMI original specifications. Larger screw size has enhanced fastening strength compared to standard products.

Miniature Linear Guides (Wide Standard Blocks) – Light Preload, Slight Clearance

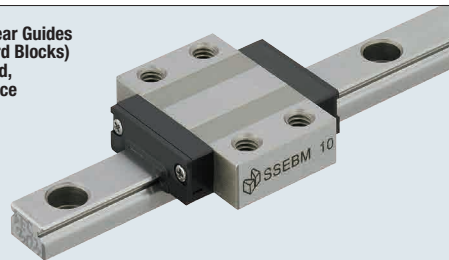

Material Hardness	Type		L Dimension	Number of Blocks
	Light Preload High Grade	Slight Clearance Standard Grade		
Stainless Steel 56 HRC min.	SSEBM	SSEBMZ	Selectable	1
	SSE2BM	SSE2BMZ		2
	SSEBML	SSEBMLZ	Configurable	1
	SSE2BML	SSE2BMLZ		2

Heat Resistant Temperature: -20–80°C

ⓘ For L Configurable, G dimensions differ from those shown in the table below. For details, P.608.

RoHS10

Features: Wide Block Type of MISUMI original specifications. Larger screw size has enhanced fastening strength compared to standard products.

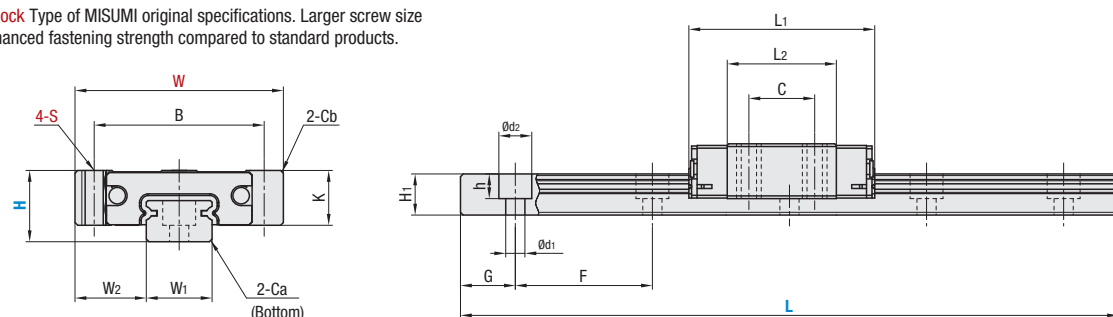

Precautions for Use

- ⓘ Blocks are equipped with retainers (wire) to prevent balls from falling out. For proper block handling, refer to P.602.
- ⓘ Radial clearances and accuracies are not guaranteed if the blocks and rails are interchanged from the original set combinations.
- ⓘ Straight grooves are provided on datum planes. When using, be sure to match the datum lines.
- ⓘ Rails cannot be connected end to end.
- ⓘ The accuracy of Linear Guides is guaranteed after mounting the rail (fastening screws on the rail and pushing it onto the datum plane). Minor bending of the rail will be adjusted after being mounted and will not affect the performance.

Accessories

– H8 comes with cap screws. (M2x6).

Others

– Filled with Lithium soap based grease (Multemp Grease PS2 by Kyodo Yushi Co., Ltd.).
– For operating life calculations, please refer to P.604, or by using our free software at, http://www.misumiusa.com/lg-bs_software/

Part Number		Block Dimensions										Guide Rail Dimensions						
Type	H	L	W	L ₁	B	C	S	L ₂	K	Cb	W ₁	W ₂	H ₁	Ca	Counterbored Holes d ₁ x d ₂ x h	F	G	
SSEBM SSE2BM SSEBML SSE2BML	SSEBMZ SSE2BMZ SSEBMLZ SSE2BMLZ	8	40–130 (70)	24	23.6	19	8	M3	13.6	6.5	0.3	7	8.5	4.7	0.3	2.4 x 4.2 x 2.3	15	5
		10	35–275 (95)	31	30	24	10	M4	19	7.8	0.3	9	11	5.5	0.3	3.5 x 6 x 3.5	20	7.5
		13	45–470 (120)	38	33.9	31	12	M4	19.9	10	0.5	12	13	7.5	0.5	3.5 x 6 x 4.5	25	10
		16	70–670 (150)	44	42.4	36	16	M4	27.4	12	0.5	15	14.5	9.5	0.5	3.5 x 6 x 4.5	40	15
		20	100–700 (160)	54	50	46	25	M5	34.6	15	0.5	20	17	11	0.5	6 x 9.5 x 5.5	60	20

ⓘ L Dimension: Dimensions in () are for the minimum rail length of the 2-Block Type

$$kgf = N \times 0.101972$$

H	Basic Load Rating		Allowable Static Moment			Mass	
	C (Dynamic) kN	Co (Static) kN	M _A N·m	M _B N·m	M _C N·m	Blocks kg	Guide Rails kg/m
8	0.9	1.5	4.1	4.1	5.2	0.015	0.19
10	1.5	2.5	5.1	5.1	10.2	0.03	0.31
13	2.2	3.3	8.8	9.5	16.1	0.05	0.61
16	3.6	5.4	21.6	23.4	39.6	0.09	1.02
20	5.2	8.5	48.4	48.4	86.4	0.17	1.65



Preload & Accuracy Standards

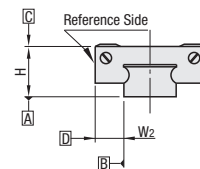

Specifications	Light Preload High Grade	Slight Clearance Standard Grade
Radial Clearance	-3–0	0–15
Height H Tolerance	±20	±20
Height H Pair Variation	15	40
Width W ₂ Tolerance	±25	±25
Width W ₂ Pair Variation	20	40
Running Parallelism of surf. C against surf. A	Refer to P.602	
Running Parallelism of surf. D against surf. B		

ⓘ Slight Clearance Type has clearance (Gap) between rails and blocks. If precision / rigidity is required, select Light Preload Type.

Miniature Linear Guides (Wide Standard Blocks)

Light Preload / Slight Clearance, continued

Part Number Example

Part Number	L
SSEBM10	- 275
SSEBM10L	- 75 L Type Greased
SSEBM10G	- 75 G Type Greased

Alternative grease types available.

Part Number Alterations

Part Number	L	(MC / RLC / LLC)
SSE2BM16	- 430 -	MC

Alterations	Code	Spec.												
Tapped Holes	MC	Changes rail mounting holes from counterbored holes to tapped holes. <table border="1"> <thead> <tr> <th>H</th> <th>MC</th> </tr> </thead> <tbody> <tr><td>8</td><td>M3</td></tr> <tr><td>10</td><td>M4</td></tr> <tr><td>13</td><td>M4</td></tr> <tr><td>16</td><td>M5</td></tr> <tr><td>20</td><td>M6</td></tr> </tbody> </table>	H	MC	8	M3	10	M4	13	M4	16	M5	20	M6
H	MC													
8	M3													
10	M4													
13	M4													
16	M5													
20	M6													
Rail Ends Cut	Left End Cut LLC Right End Cut RLC	Rail ends cut. Ordering Code: LLC <table border="1"> <thead> <tr> <th>H</th> <th>L Cut</th> <th>N</th> </tr> </thead> <tbody> <tr><td>10</td><td>2.5</td><td>5</td></tr> <tr><td>13</td><td>5</td><td>5</td></tr> <tr><td>16</td><td>10</td><td>5</td></tr> </tbody> </table> <ul style="list-style-type: none"> ⓘ Applicable to Selectable Type only. ⓘ Cutting will shorten overall length. ⓘ Not applicable to H8, 20. ⓘ Not applicable to L35 of H10 and L45 of H13. 	H	L Cut	N	10	2.5	5	13	5	5	16	10	5
H	L Cut	N												
10	2.5	5												
13	5	5												
16	10	5												
3-Block Specifications	B3	Adds 2-blocks to the 1-block product. ⓘ There are restrictions for the L dimension length. See "Selectable Shortest Rail Length" for details. Selection Example: SSEBM10-275-B3												
3-Block Specifications	B4	Adds 3-blocks to the 1-block product. ⓘ There are restrictions for the L dimension length. See "Selectable Shortest Rail Length" for details. Selection Example: SSEBML13-275-B4												

Selectable Shortest Rail Length for B3/B4

H	B3 (3-block)	B4 (4-block)
8	85	115
10	115	155
13	145	170
16	190	230
20	220	280

Options for Linear Guide

Positioning Retaining Parts	Block / Rail Fixing Parts
	Rail Push Plates
Rail Height Adjusting Blocks	Linear Lock
Stopper Bolts	Linear Guide Lock Units

Application Example

