

Shaft Supports (Flanged Mount)

Standard Type with Through or Tapped Mounting Holes / Long Sleeve Type

Feature: Tapped Mounting Hole Type is suitable when tapping is difficult due to mounting plate strength (aluminum) or thickness.

Type	Through Mounting Holes			Tapped Mounting Holes		Material	Surface Treatment
	Round Flanged	Square Flanged	Compact Flanged	Round Flanged	Compact Flanged		
Standard	STHRB	STHSB	STHCB	STHRBT	STHCBT	1018 Carbon Steel or Equivalent	Black Oxide
	STHR	STHS	STHC	STHRT	STHCT	304 Stainless Steel	Electroless Nickel Plating
	SSTHR	SSTHS	SSTHC	SSTHRT	SSTHCT		—
	ATHR	ATHS	ATHC	—	—	Aluminum Alloy	Clear Anodize
	BTHR	—	BTHC	—	—		Black Anodize
Long Sleeve	STHRBL	STHSBL	STHCBL	—	—	1018 Carbon Steel or Equivalent	Black Oxide
	STHRL	STHSL	STHCL	—	—	304 Stainless Steel	Electroless Nickel Plating
	SSTHRL	SSTHSL	SSTHCL	—	—		—
	—	—	—	—	—	—	—

For included Hex Socket Set Screw, refer to Alterations.

Standard with Through / Tapped Mounting Holes

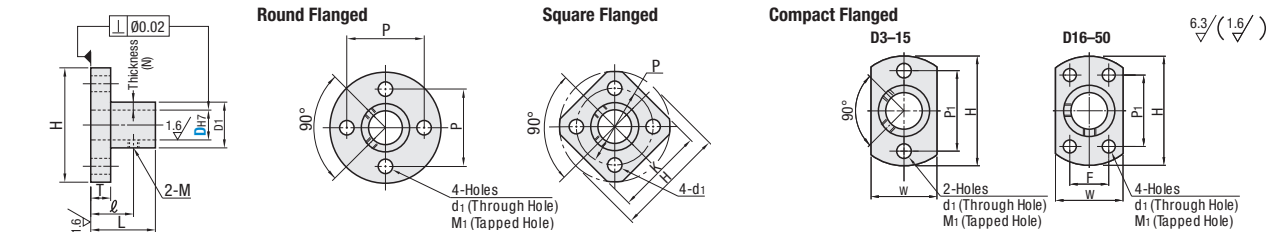

Long Sleeve

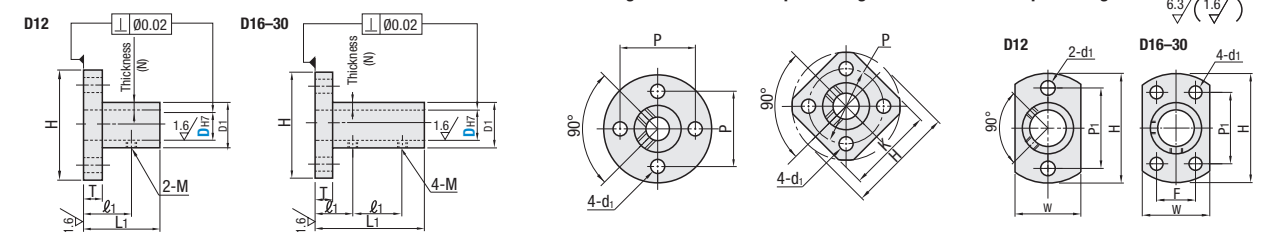

Part Number		Sleeve Thickness (N)	L	L ₁	D ₁	H	T	ℓ	ℓ ₁	M (Coarse)	P	K	W	P ₁	F	d ₁	M ₁ (Coarse)
Type	D _{H7}																
Standard with Through Mounting Holes																	
Round Flanged	3	+0.010 0	10	—	8	22	3	7	—	M3	15	16	8	15	—	3.5	—
Square Flanged	4	+0.012 0	10	—	9	24	3.5	7	—	M3	17	19	9	17	—	3.5	—
Compact Flanged	5	+0.012 0	12	—	10	25	3.5	7	—	M3	18	20	10	18	—	3.5	—
STHRB	6	+0.015 0	15	—	12	28	3.5	7	—	M3	20	22	12	20	—	3.5	—
STHR	8	+0.015 0	16	—	12	28	3.5	7	—	M4	20	22	16	20	—	4.5	M4
SSTHR	10	+0.015 0	20	—	14	30	5	10	—	M3	22	23	18	22	—	3.5	—
ATHR	10M ²	+0.015 0	20	—	14	30	5	12	—	M4	22	23	18	22	—	4.5	M4
BTHR	10M ²	+0.015 0	20	—	14	30	5	12	—	M4	22	23	18	22	—	4.5	M4
Standard with Tapped Mounting Holes																	
Only for D dimension denoted with "2" mark																	
STHRBT	13	+0.018 0	24	30	16	36	6	15	15	M4	26	28	20	26	—	4.5	M4
STHRT	15 ²	+0.018 0	30	—	18	38	6	18	—	M4	28	30	22	28	—	4.5	M4
SSTHRT	15 ²	+0.018 0	30	—	20	40	6	18	—	M4	30	32	24	30	—	4.5	M4
—	18	+0.018 0	32	48	22	42	6	19	16	M4	32	33	26	28	16	4.5	M4
—	18	+0.018 0	32	48	28	50	8	20	—	M5	39	39	32	31	22	5.5	M5
—	20 ²	+0.021 0	32	48	28	50	8	20	16	M5	39	39	32	31	22	5.5	M5
—	25 ²	+0.021 0	32	48	33	55	8	23	19	M5	44	44	37	36	24	5.5	M5
—	30 ²	+0.021 0	32	48	38	66	10	24	19	M5	52	52	42	41	27	6.6	M6
—	35 ²	+0.025 0	5	—	45	80	10	—	—	M6	65	65	55	56	33	9	M8
—	40 ²	+0.025 0	5	—	75	75	65	65	38	M6	75	75	65	65	38	9	M8
—	50 ²	+0.025 0	10	50	60	90	10	30	—	M6	85	90	75	74	43	9	M8

Tapped Mounting Hole Type is available only for D dimension denoted with "2" mark. Long Sleeve Type is available only for D dimension denoted with "1" mark. Only 1018 Carbon Steel or Equivalent and 304 Stainless Steel are applicable to D dimension 8M and 10M (6061 Aluminum Alloy is not applicable).

Standard

D	Available Types													
	Round Flanged				Square Flanged				Compact Flanged					
	STHRB	STHR	SSTHR	ATHR	BTHR	STHSB	STHS	SSTHS	ATHS	STHCB	STHC	SSTHC	ATHC	BTHC
3	*	*	*	*	*	*	*	*	*	*	*	*	*	*
4	*	*	*	*	*	*	*	*	*	*	*	*	*	*
5	*	*	*	*	*	*	*	*	*	*	*	*	*	*
6	*	*	*	*	*	*	*	*	*	*	*	*	*	*
8 8M ²	*	*	*	*	*	*	*	*	*	*	*	*	*	*
10 10M ²	*	*	*	*	*	*	*	*	*	*	*	*	*	*
12 ²	*	*	*	*	*	*	*	*	*	*	*	*	*	*
13	*	*	*	*	*	*	*	*	*	*	*	*	*	*
15 ²	*	*	*	*	*	*	*	*	*	*	*	*	*	*
16 ²	*	*	*	*	*	*	*	*	*	*	*	*	*	*
18	*	*	*	*	*	*	*	*	*	*	*	*	*	*
20 ²	*	*	*	*	*	*	*	*	*	*	*	*	*	*
25 ²	*	*	*	*	*	*	*	*	*	*	*	*	*	*
30 ²	*	*	*	*	*	*	*	*	*	*	*	*	*	*
35	*	*	*	*	*	*	*	*	*	*	*	*	*	*
40	*	*	*	*	*	*	*	*	*	*	*	*	*	*
50	*	*	*	*	*	*	*	*	*	*	*	*	*	*

Long Sleeve

D	Unit Price													
	Round Flanged				Square Flanged				Compact Flanged					
	STHRBL	STHRL	SSTHRL	STHSBL	STHSL	SSTHSL	STHCL	STHCL	SSTHCL	STHCL	STHCL	SSTHCL		
12	*	*	*	*	*	*	*	*	*	*	*	*	*	*
16	*	*	*	*	*	*	*	*	*	*	*	*	*	*
20	*	*	*	*	*	*	*	*	*	*	*	*	*	*
25	*	*	*	*	*	*	*	*	*	*	*	*	*	*
30	*	*	*	*	*	*	*	*	*	*	*	*	*	*

Caution in Selection of Standard Type

Tapped Mounting Hole Type is available only for D dimension denoted with "2" mark. Aluminum is not available for products with D dimension 8M and 10M.

Shaft Supports (Flanged Mount)

With Pilot / With Dowel Hole

Feature: Easy positioning during assembly.

Flanged Mount – With Pilot	Round Flanged	Square Flanged	Compact Flanged	Material	Surface Treatment
	STHRB	STHSB	STHCB		
STHR	STHS	STHC	304 Stainless Steel	Electroless Nickel Plating	
SSTHR	SSTHS	SSTHC		—	

To include Hex Socket Set Screw, refer to Alterations.

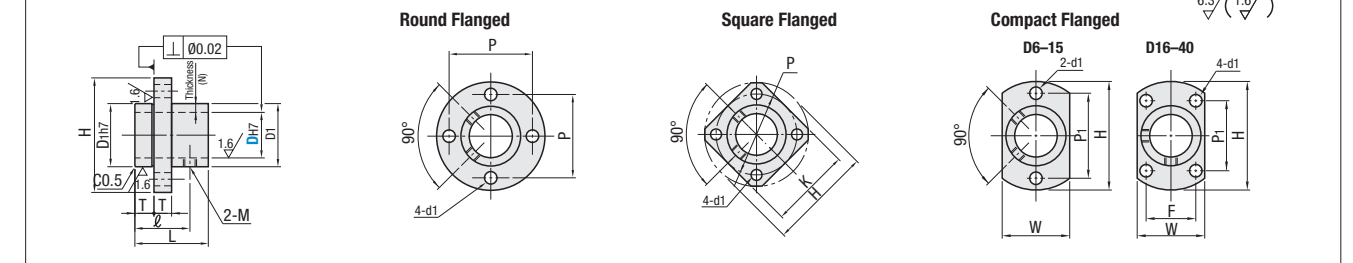

Part Number		Sleeve Thickness (N)	L	D ₁	H	T	ℓ	M (Coarse)	P	K	W	P ₁	F	d ₁	
Type	D _{H7}														
Round Flanged STHRB STHR SSTHR	6	+0.012 0	3	15	12	28	3.5	11	M3	20	22	12	20	3.5	
	8	+0.015 0	2	18	14	30	5	14	M4	22	23	16	20	4.5	
	8M ²														
	10														
	10M ²	+0.018 0	2.5	20	16	36	6	18	M4	26	28	20	26	4.5	
	12														
	15														
	16														
	20	+0.021 0	4	32	28	50	8	24	M5	39	39	32	31	22	5.5
	25														
	30														
	40	+0.025 0	10	50	60	90	10	35	M6	75	75	65	65	38	9

Flanged Mount – With Dowel Holes	Round Flanged	Compact Flanged	Material	Surface Treatment
	STHRBK	STHCBK		
STHRK	STHCK	304 Stainless Steel	Electroless Nickel Plating	
SSTHRK	SSTHCK		—	

To include Hex Socket Set Screw, refer to Alterations.

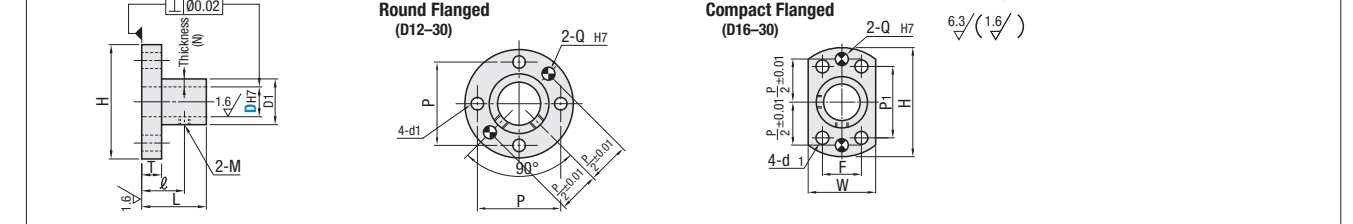

Part Number		Sleeve Thickness (N)	L	D ₁	H	T	ℓ	M (Coarse)	P	W	P ₁	F	d ₁	Q
Type	D _{H7}													
Round Flanged STHRBK STHRK SSTHRK	12	2	24	16	36	6	15	M4	26	20	28	—	4.5	4
	13													
	15													
	16	2.5	32	22	42	6	19	M4	32	26	28	16	5	
	18													
	20													
25	+0.021 0	4	32	28	50	8	20	M5	39	32	31	22	5.5	
30														
30	+0.021 0	4	38	38	66	10	24	M6	52	42	41	27	6.6	

Compact Flange Type is available only for D dimensions 16-30.

Part Number Example

Part Number
STHRL10
STHS20
SSTHCK20

Part Number Alterations

Part Number - (MB)
STHR10 - MB
STHRL20 - MB

Alterations	Hex Socket Set Screw included	
Code	MB	
Spec.	Hex socket set screws come with as a set. Screw head can protrude from outer cylinder (D ₁). Included screws are 4137 Alloy Steel (Black Oxide) for Black Oxide and Black Anodized products. Included screws are Stainless Steel for other products. Long Sleeve Type comes with 4 set screws; others with 2 set screws.	
	D	M x Length
	3, 4, 5, 6, 8, 10	M3 x 3
	8M, 10M, 12, 13, 15, 16	M4 x 3
	18, 20, 25	M5 x 4
30, 35, 40, 50	M6 x 5	