

# Counterbores in Specified Position

# D Type Hole Alterations

Blind Joints which require this alteration

Single Joints  
P669

Counterbores useable for various purposes are added at customer specified locations.

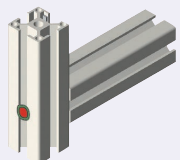

**Top to Bottom (Vertical)**  
XA XB XC XD XE

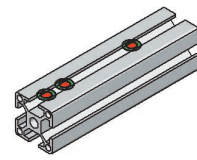

Counterbore is added on every slot for multiple slotted extrusions.

**Right to Left (Horizontal)**  
YA YB YC YD YE

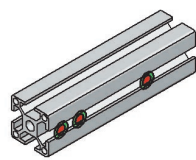

**Cross Section View**

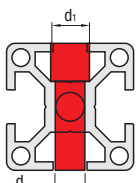

### Alteration Code Specification Method

As for the Counterbore, it is possible to select one type of hole diameter in Z selection and specify up to five holes in one direction.  
Specify the desired hole position from the left end.

Alterations	Counterboring			
Code	Extrusion Series	Z	d	d1
HFS5	5	5.5	9.5	
HFS6	6	6.5	11	
HFS7	7	7.5	12	
HFS8	8	8.5	14	
HFS8(45)	6	6.5	11	
GF58	8	9	14	
GF58	12	13	19	

Feature	Alterations				Counterbores in Specified Position					
	Type	Code	No.	Page	Counterbored	From Top to Bottom	From Right to Left	From Right to Left		
4-Side Slots	HFS5	5	5.5	9.5	Z5 d5.5 d1 9.5					
	HFS6	6	6.5	11						
	HFS7	7	7.5	12						
	HFS8	8	8.5	14						
	GF58	8	9	14						
	GF58	12	13	19						
	3-Side Slot 1-Side Flat									
	2-Side Slots 2 Flats									
	2 Slots on Opposite Sides 1-Side Slot 3 Flats									
	Angled									
Black Anodize										
Curved										

**Ordering Example**  
Part Number  
HFS6-3030-500-Z6-XA200-XB256

**Days to Ship** [Configure Online](#)

Feature	Alterations				Counterbores in Specified Position					
	Type	Code	No.	Page	Counterbored	From Top to Bottom	From Right to Left	From Right to Left		
4-Side Slots	HFS8	8	8.5	14	Z6 d6.5 d1 11					
	GF58	8	9	14						
	GF58	12	13	19						
	3-Side Slot 1-Side Flat									
	2-Side Slots 2 Flats									
	2 Slots on Opposite Sides									
	1-Side Slot 3 Flats									
	Light Type									
	Angled									
	Black Anodize									
Curved										

Adds D Holes for Single Joint connections.

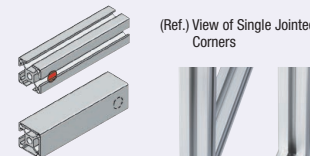

D Holes do not penetrate through the smooth sides, enabling esthetically pleasing connections.

**Horizontal on Left End**  
LDH



**Horizontal on Right End**  
RDH

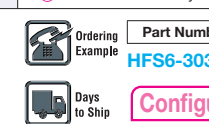

**Vertical on Left End**  
LDV



**Vertical on Right End**  
RDV



**Cross Section View**

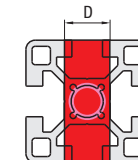

Hole Position and Size	D Hole	
Extrusion Series	H(mm)	ØD(mm)
HFS6	15	11.1
HFS8	20	13.1
HFS8-45	22.5	15.1

**Ordering Example**  
Part Number  
HFS6-3030-2000-LDH-RDH

**Days to Ship** [Configure Online](#)

Alterations	Code	No.	Page	D Hole Dia.	D Hole				
					Left Side	Right Side	Horizontally/Vertically	Horizontally/Vertically	
Feature	Type	Code	No.	Page	LDH	LDV	RDH	RDV	
4-Side Slots	HFS6	6	6.5	11					
	NFS6	6	6.5	11					
	GF56	6	6.5	11					
	GF56	12	13	19					
	3-Side Slot 1-Side Flat								
	2-Side Slots 2 Flats								
	2 Slots on Opposite Sides								
	1-Side Slot 3 Flats								
	Light Type								
	Angled								
Black Anodize									
Curved									

Alterations	Code	No.	Page	D Hole Dia.	D Hole				
					Left Side	Right Side	Horizontally/Vertically	Horizontally/Vertically	
Feature	Type	Code	No.	Page	LDH	LDV	RDH	RDV	
4-Side Slots	HFS6	6	6.5	11					
	NFS6	6	6.5	11					
	GF56	6	6.5	11					
	GF56	12	13	19					
	3-Side Slot 1 Flat								
	2-Side Slots 2 Flats								
	2 Slots on Opposite Sides								
	1-Side Slot 3 Flats								
	Light Type								
	Angled								
Black Anodize									
Curved									

Alterations	Code	No.	Page	D Hole Dia.	D Hole				
					Left Side	Right Side	Horizontally/Vertically	Horizontally/Vertically	
Feature	Type	Code	No.	Page	LDH	LDV	RDH	RDV	
4-Side Slots	HFS6	6	6.5	11					
	NFS6	6	6.5	11					
	GF56	6	6.5	11					
	GF56	12	13	19					
	3-Side Slot 1 Flat								
	2-Side Slots 2 Flats								
	2 Slots on Opposite Sides								
	1-Side Slot 3 Flats								
	Light Type								
	Angled								
Black Anodize									
Curved									

### Standard of Extrusion Position

Placing method of the extrusion, which is a basis to determine right and left is shown as follows.

- On the vertical length
- Flat side down
- One flat side down and another flat side right

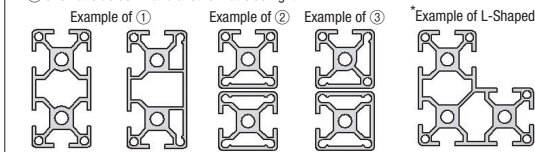

When the extrusion is on the vertical length and also has a flat side, ① has the priority.

### Notes on Flat Sided Extrusions

Counterbores cannot be made from smooth extrusion sides, but can be made from slotted sides through the smooth sides.

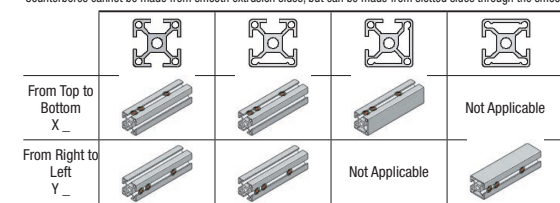

### Standard of Extrusion Position

Placing method of the extrusion, which is a basis to determine right and left is shown as follows.

- On the vertical length
- Flat side down
- One flat side down and another flat side right

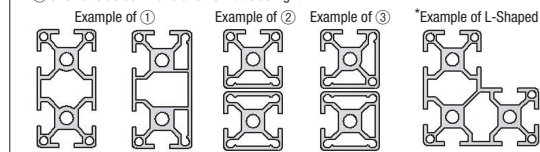

When the extrusion is on the vertical length and also has a flat side, ① has the priority.

### Additional Info. on Smooth Sided Extrusions

D Holes in flat surface direction are blind holes, and do not penetrate through the flat surface.

- D holes and wrench access holes can be added using a jig on P.786.

