

Position Digital Indicators - Overview

Feature

Digital Display is easy to read.

Positioning and determination with Feed Screw is easy.

It prevents wrong setting caused by error in display indication when the screw mechanism is changed at the factory.

Various Lineup

MISUMI Digital Position Indicators are designed to use in combination with our Lead Screws. Two sizes of display, three mounting types, two colors are available.

4-Digit and 5-Digit indication and With Counter Reset are available.

Mounting Position	Standard Spindle	Front Spindle	Vertical Spindle	Counter Indication
Large (with Counter Reset)				5-Digit Type Dimensions: 4.1, 5.8, 5.5, 1/10, 1/100
Compact				4-Digit Type 5-Digit Type Dimensions: 3.6, 5.2, 4.8, 1/10, 1/100 · The leftmost position is blank on the 4-digit counter.

Large

Color	Display Digits	Feed Screw Pitch (Display Number per Revolution)
Orange	Silver	5-Digit
		3 4 5 6

- With Counter Reset
- Applicable to mounting shaft end dia. 12, 14, 15, 16, 17 and 20.
- ***When used with a lead screw with the same pitch, display number and pitch number will be the same.**

Compact

Color	Display Digits	Feed Screw Pitch (Display Number per Revolution)
Orange	Silver	4-Digit
		5-Digit
		2 3 4 5 6

- 4-Digit Type and 5-Digit Type are available for the same size.
- Applicable to mounting shaft end dia. 6, 8, 10, 12 and 14.
- ***When used with a lead screw with the same pitch, display number and pitch number will be the same.**

Color



Usage

Can be used to confirm the present setting position such as the transfer of table that utilizes screw feed mechanism and the slide adjustment.

Conventional Method: Reading errors occur.

When Indicator is Used: Digital indication reduces the reading errors.

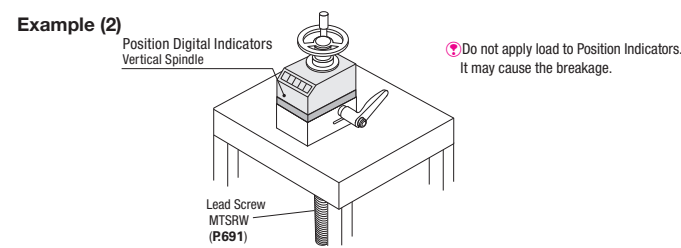
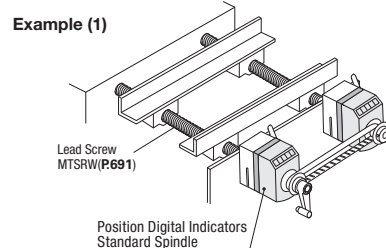
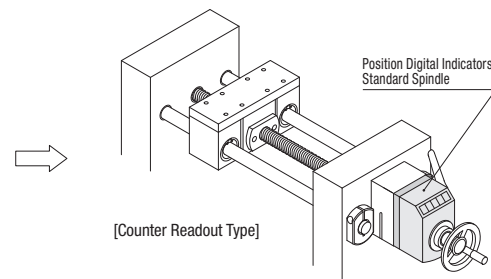
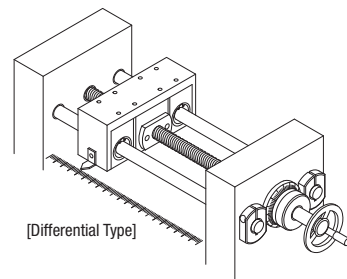

How to Mount: Large

① Provide a hole used for locating.

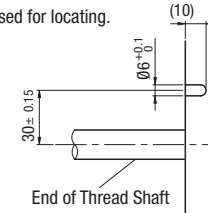

(Not necessary if a clamp plate is used.)

② Mount the included cushion sheet and pass it through the screw shaft.

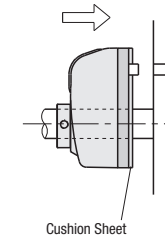

③ Make sure that the screw shaft is in the correct position and that the indicator is set at 0, fix it with the included set screw. * Large Position Indicators can be mounted same as Compact Position Indicators.

Caution
Do not move the position indicator with screws installed on the shaft. It may cause the breakage.

How to Mount: Compact

① Provide a hole used for locating.

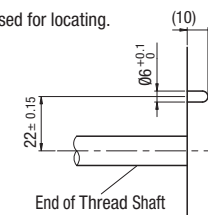

(Not necessary if a clamp plate is used.)

② Mount the included cushion sheet and pass it through the screw shaft.

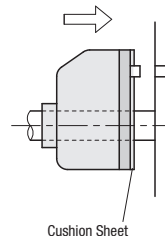

③ Set the indicator at "0" and then fix it with the attached set screws.

Caution
Do not move the position indicator with screws installed on the shaft. It may cause the breakage.

Counter Reset Procedures (Only for Large Type)

- ① Take off the caps of side holes. (For the position of holes, refer to the figure below.)
- ② Insert a hex wrench (3mm hex), and turn it either direction within 40°.
- ③ Stop turning the wrench when the counter indicates all zeros. Then turn the wrench back to the original position.

Standard Spindle

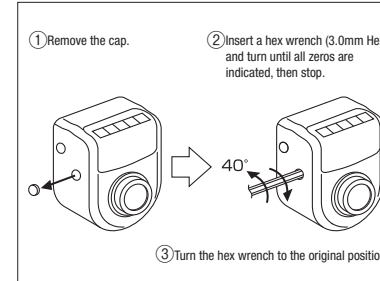

Front Spindle

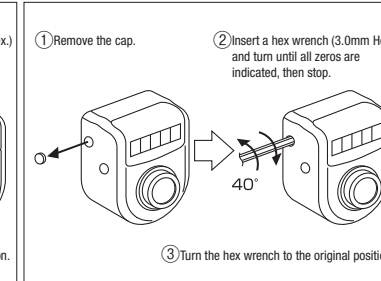

Vertical Spindle

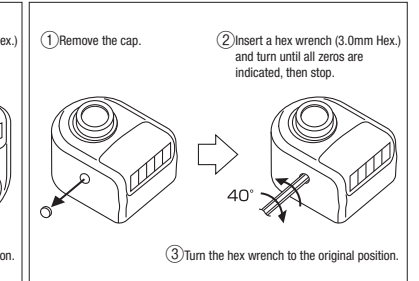

Caution

Turning the wrench more than necessary may cause damages on the unit. Turn the wrench slowly. Please note that there should be space for hex wrench.

Notes

- The count goes up depending on turning distance, as the screw shaft (lead screw, slide screw, etc.) is turned clockwise. The count goes down as the screw shaft is turned counterclockwise.
- The rotational speed at the start-up should not exceed 1/3 of maximum rotational speed (rpm).
- Must not be abruptly accelerated or decelerated.
- Do not use a motorized driver. It may cause the breakage.
- Do not use when shafts move to the thrust (shaft) direction. It may cause the breakage.

Selection of Position Indicator Collar

① Position Indicator ② has a fixed I.D. (Large: I.D. 20mm, Compact: I.D. 14mm)

Shafts ③ whose O.D. is less than 20mm (Large) / 14mm (Compact) are used with a collar ① attached.

Indicator Collar Details P.701, 702

Indicator Collar Selection Chart

Indicator Shaft O.D.	Indicator Alteration Part Number
Ø6	-CSE6
Ø8	-CSE8
Ø10	-CSE10
Ø12	-CSE12
Ø14	-CSE14
Ø15	-CSE15
Ø16	-CSE16
Ø17	-CSE17

