

Floating Joints

—Low Hardness—



Floating Joints connect air cylinder rods to moving machine parts. They are extremely compact, economical and able to absorb substantial mounting misalignments. Since the floating joints below are the Low Hardness Type, use them in low load and low speed applications.

Components	Material	Surface Treatment	Hardness	Type
Complete Sets	1045 Steel	Black Oxide	28-33HRC (Cylinder Connector)	U-FJCF
	304 Stainless Steel	-	-	U-FJCF-S
Cylinder Connector Only	1045 Steel	Black Oxide	28-33HRC	U-FJCF-C
	304 Stainless Steel	-	-	U-FJCF-S-C
Mount Flange Only	1045 Steel	Black Oxide	-	U-FJCF-H
	304 Stainless Steel	-	-	U-FJCF-S-H

Material Characteristics P.628, 629

Mounting Flanges
0.38 0.50-0.75

2 x d thru c-bore d1, dp, H1 C x 45°-4Plc's 4 x d thru c-bore d1, dp, H1 C x 45°-4Plc's

Cylinder Connectors **Complete Sets**

15° 0.015 x 45° R0.008 0.030 x 45° T

H D2 D h +0.000 -0.005 L 25° W

W1 F d d1 H1 C

General Tolerance
Unless otherwise specified use the table below.

From	To	Tolerance
0.000	5.000	±0.01
5.001	16.000	±0.02
16.001	60.000	±0.05

Thread or hole location tolerance: ±0.005' non-cumulative.

Surface Roughness: Unless otherwise specified

Type	Part No.	T (Thread)			\$ Unit Price (Qty. 1-4)						
		Callout	Size	Major Dia.	U-FJCF	U-FJCF-S	U-FJCF-C	U-FJCF-S-C	U-FJCF-H	U-FJCF-S-H	
Complete Sets	Cylinder Connectors	Mounting Flanges	0.38	3/8-24	0.375	13.10	22.60	6.40	9.30	8.70	15.30
			0.50	1/2-20	0.500	17.40	30.30	8.20	11.80	11.20	20.50
			0.63	5/8-18	0.625	25.30	40.10	9.50	15.10	16.70	27.00
			0.75	3/4-16	0.750	29.00	53.90	11.70	20.90	18.00	35.00

Order Example The part number consists only of the fields with blue characters. Please refer to the table below for technical information.

Part No. _____

Type T

U-FJCF 0.50

U-FJCF-C 0.50

U-FJCF-H 0.50

Technical Information for Mounting Flanges

T (Thread)	Mounting Flanges												
Callout	A	G	B	G1	W1	D1	t	F	d	d1	H1	C	
0.38	2.00	1.44	0.94	-	0.781	0.656	0.250	0.56	0.281	0.438	0.281	0.15	
0.50	2.25	1.69	1.25	0.69	1.047	0.922	0.313	0.63	0.281	0.438	0.281	0.15	
0.63	2.81	2.13	1.50	0.81	1.297	1.172	0.375	0.69	0.344	0.531	0.344	0.15	
0.75	3.38	2.50	1.75	0.94	1.500	1.313	0.406	0.75	0.406	0.625	0.406	0.20	

Technical Information for Cylinder Connectors

T (Thread)	Cylinder Connectors						
Callout	L	D	D2	H	h	W	
0.38	0.63	0.625	0.56	0.938	0.250	0.750	
0.50	0.75	0.875	0.66	1.250	0.313	1.000	
0.63	0.81	1.125	0.88	1.500	0.375	1.250	
0.75	0.88	1.250	1.00	1.750	0.406	1.438	

Days to Ship 1 Day

Quantity Discount Rate

Quantity	1-4	5-9	10-19	20-
Rate	—	2%	3%	5%

For larger quantity orders 'Days to Ship' may differ from published catalog term. P.29

Backing Plates



Material	Surface Treatment	Hardness	Type
1045 Steel	Black Oxide	28-33HRC	U-BPFJ
304 Stainless Steel	-	-	U-BPFJS

Material Characteristics P.628, 629

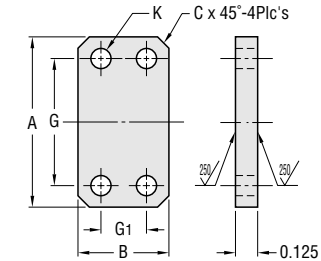

General Tolerance
Unless otherwise specified use the table below.

From	To	Tolerance
0.000	5.000	±0.01
5.001	16.000	±0.02
16.001	60.000	±0.05

Thread or hole location tolerance: ±0.005' non-cumulative.

Only "0.38" has two holes.
Surface Roughness: Unless otherwise specified

Part No.	Type	Callout	A	G	B	G1	K	C	\$ Unit Price (Qty. 1-4)	
									U-BPFJ	U-BPFJS
U-BPFJ U-BPFJS		0.38	2.00	1.44	0.94	-	0.281	0.15	3.40	3.70
		0.50	2.25	1.69	1.25	0.69	0.281	0.15	4.20	4.50
		0.63	2.81	2.13	1.50	0.81	0.344	0.15	6.10	6.40
		0.75	3.38	2.50	1.75	0.94	0.406	0.20	7.80	8.10

Order Example The part number consists only of the fields with blue characters.

Part No. _____

Type Callout

U-BPFJ 0.50

Days to Ship 1 Day

Quantity Discount Rate

Quantity	1-4	5-9	10-19	20-
Rate	—	2%	3%	5%

For larger quantity orders 'Days to Ship' may differ from published catalog term. P.29

Example

